

C.I.P.**12,7 X 42**

TAB.

I

Date

21-11-09

Country of Origin: IT

Revision

Alternative Names: 500 DR

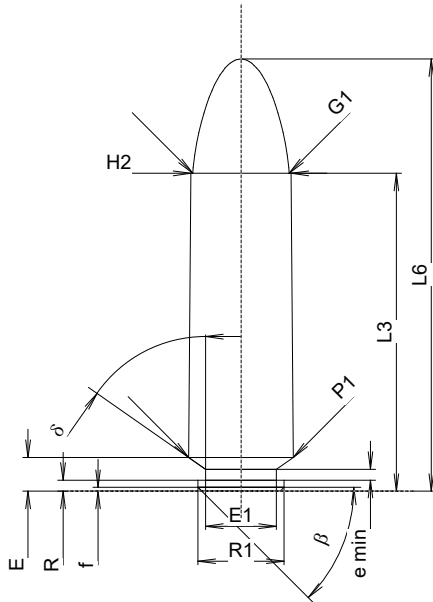
**CARTRIDGE MAXI****Lengths**

L1	=		
L2	=		
L3 ¹⁾	=	42.04	-0.25
L4	=		
L5	=		
L6	=	57.15	

Case Head

R	=	1.45	
R1	=	11.35	
R3	=		
E	=	4.46	
E1	=	9.35	
e min	=	1.45	
delta	=	55°	
f	=	0.50	
beta	=	45°	

Powder Chamber

P1	=	13.82	
P2	=		

Junction Cone

alpha	=		
S	=		
r1 min	=		
r2	=		

Collar

H1	=		
H2 ¹⁾	=	13.26	

Projectile

G1 ¹⁾	=	12.75	
G2	=		
F	=		
L3+G	=	45.59	

Pressures (Energies)**Method Transducer**

Pmax	=	2400 bar	
PK	=	2760 bar	
PE	=	3000 bar	
M	=	25.00	
EE	=	4000 Joule	

Miscellaneous Dimensions

Fe ¹⁾⁶⁾	=	0.15	
delta L	=		

CHAMBER MINI**Lengths**

L1	=		
L2	=		
L3 ¹⁾	=	42.10	

Breech

R	=		
R1	=	13.88	
R2	=		
R3	=		
r	=		

Powder Chamber

E	=	4.47	
P1 ¹⁾	=	13.84	
P2	=		

Junction Cone

alpha	=		
S	=		
r1 max	=		
r2	=		

Collar

H1	=		
H2 ¹⁾	=	13.28	

Commencement of Rifling

G1 ^{1)*}	=	12.78	
G ¹⁾	=	3.55	
alpha1	=	180°	
h	=		
s	=		
i ^{1)*}	=	2°49'19"	
w	=		

Barrel

F ^{1)*}	=	12.43	
Z ¹⁾	=	12.73	

Grooves

b	=	3.43	
N	=	6	
u	=	16.00	
Q	=	124.47	mm ²

Scale 1:1

Dimensions in << mm >>
Dimensions and Tolerances for Proof Barrels
see Appendix CR1.

Notes: 1) Check for safety reasons
6) Headspace on Case Mouth
* Basic dimensions