

**C.I.P.****222 Rem. Mag.**

TAB.

I

Date

84-06-14

Revision

22-04-26

Country of Origin: US

**CARTRIDGE MAXI****CHAMBER MINI****Lengths**

L1 <sup>1)</sup>	=	37.18	-0.20
L2 <sup>1)</sup>	=	40.29	-0.20
L3 <sup>1)</sup>	=	46.99	
L4	=		
L5	=		
L6	=	57.91	

**Lengths**

L1	=	37.07
L2	=	40.15
L3 <sup>1)</sup>	=	47.29

**Case Head**

R	=	1.14
R1	=	9.60
R3	=	
E	=	3.11
E1	=	8.43
e min	=	0.76
$\delta$	=	25°
f	=	0.45
$\beta$	=	35°

**Breech**

R	=	
R1	=	9.63
R2	=	
R3	=	
r	=	

**Powder Chamber**

P1	=	9.56
P2 <sup>1)</sup> *	=	9.07 -0.20

**Powder Chamber**

E	=	3.11
P1 <sup>1)</sup>	=	9.59
P2 *	=	9.09

**Junction Cone**

$\alpha$ *	=	46°
S *	=	47.86
r1 min	=	0.64
r2	=	2.54

**Junction Cone**

$\alpha$ <sup>1)</sup> *	=	46°
S *	=	47.78
r1 max	=	0.64
r2	=	3.18

**Collar**

H1 *	=	6.43
H2 <sup>1)</sup>	=	6.43

**Collar**

H1 *	=	6.48
H2 <sup>1)</sup>	=	6.45

**Projectile**

G1 <sup>1)</sup>	=	5.70
G2	=	
F	=	
L3+G <sup>1)</sup>	=	49.18

**Commencement of Rifling**

G1 <sup>1)</sup> *	=	5.69
G <sup>1)</sup>	=	2.19
$\alpha$ 1	=	90°
h	=	0.38
s *	=	1.02
i <sup>1)</sup> *	=	3°10'36"
w	=	

**Pressures (Energies)****Method Transducer**

Pmax	=	4050 bar
PK	=	4658 bar
PE	=	5060 bar
M	=	25.00
EE	=	1820 Joule

**Barrel**

F <sup>1)</sup> *	=	5.56
Z <sup>1)</sup>	=	5.69

**Grooves**

b	=	2.03
N	=	6
u	=	356.00
Q	=	25.09 mm <sup>2</sup>

**Miscellaneous Dimensions**

Fe <sup>1)</sup>	=	0.10
delta L	=	0.09

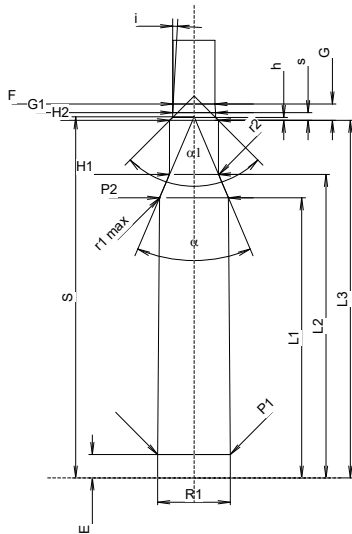
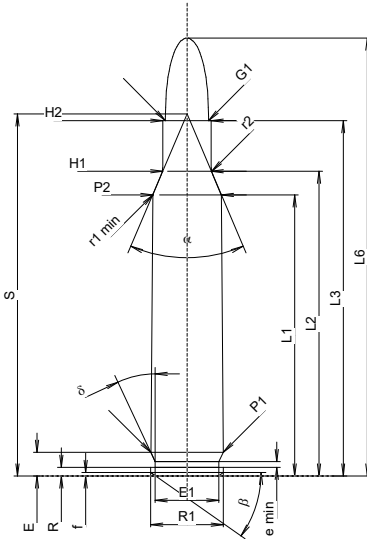

Scale 1:1

Dimensions in << mm >>  
Dimensions and Tolerances for Proof Barrels  
see Appendix CR 1.

Notes: 1) Check for safety reasons  
\* Basic dimensions