

**C.I.P.****26 Nosler**

TAB.

I

Datum

21-11-09

Ursprungsland: US

Revision

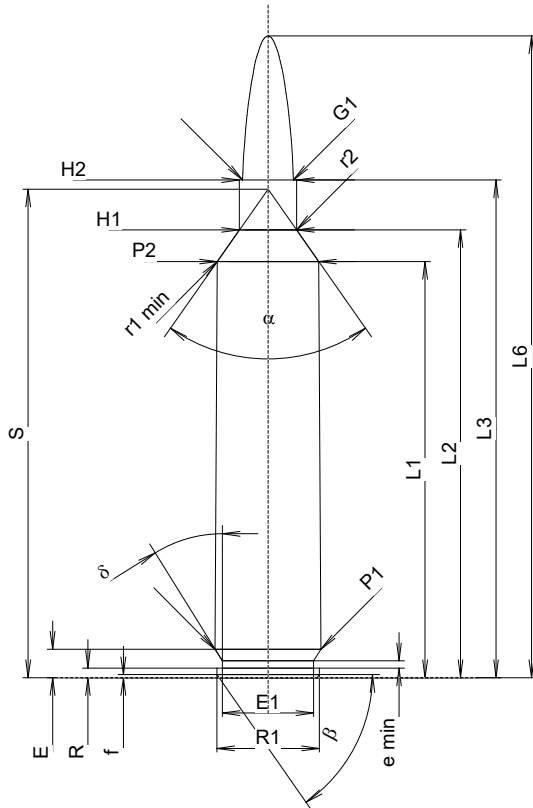
**PATRONE MAXI****Längen**

L1 <sup>1)*</sup>	=	55.01	-0.20
L2 <sup>1)*</sup>	=	59.20	-0.20
L3 <sup>1)</sup>	=	65.79	
L4	=		
L5	=		
L6	=	84.84	

**Hülsenboden**

R	=	1.27	
R1	=	13.56	
R3	=		
E	=	3.75	
E1	=	12.07	
e min	=	0.94	
delta	=	32°	
f	=	0.38	
beta	=	55°	

**Pulverkammer**

P1	=	13.99	
P2 <sup>1)*</sup>	=	13.40	-0.20

**Schulterkonus**

alpha	=	70°	
S	=	64.58	
r1 min	=	0.76	
r2	=	3.18	

**Hülsenhals**

H1 *	=	7.54	
H2 <sup>1)</sup>	=	7.54	

**Geschoss**

G1 <sup>1)</sup>	=	6.73	
G2	=		
F	=		
L3+G <sup>1)</sup>	=	73.57	

**Drücke (Energien)****Mech. elektr. Wandler**

Pmax	=	4400 bar	
PK	=	5060 bar	
PE	=	5500 bar	
M	=	25.00	
EE	=	4500 Joule	

**Verschiedene Daten**

Fe <sup>1)3)</sup>	=	0.10	
delta L	=	0.10	

**PATRONENLAGER MINI****Längen**

L1 *	=	54.90	
L2 *	=	59.07	
L3 <sup>1)</sup>	=	66.04	

**Stoßboden**

R	=		
R1	=	14.05	
R2	=		
R3	=		
r	=		

**Pulverkammer**

E	=	3.75	
P1 <sup>1)</sup>	=	14.01	
P2 *	=	13.43	

**Schulterkonus**

alpha <sup>1)</sup>	=	70°	
S	=	64.49	
r1 max	=	0.76	
r2	=	3.18	

**Hülsenhals**

H1 *	=	7.59	
H2 <sup>1)</sup>	=	7.57	

**Geschossübergang**

G1 <sup>1)*</sup>	=	6.73	
G <sup>1)*</sup>	=	7.78	
alpha1	=	90°	
h	=	0.42	
s *	=	3.42	
i	=	1°30'	
w	=		

**Lauf**

F <sup>1)*</sup>	=	6.50	
Z <sup>1)</sup>	=	6.71	

**Züge**

b	=	2.41	
N	=	4	
u	=	203.20	
Q	=	34.22	mm <sup>2</sup>

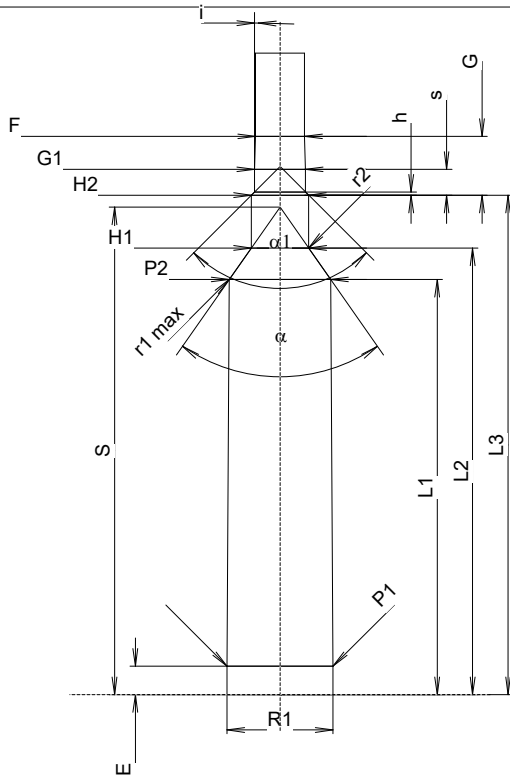

Maßstab 1:1

Maße in << mm >>  
Maße und Toleranzen für Messläufe  
siehe Anhang CR1.

Bemerkungen:

1) Kontrolle aus Sicherheitsgründen  
3) Verschlussabstand an Schulter  
\* Grundmaße