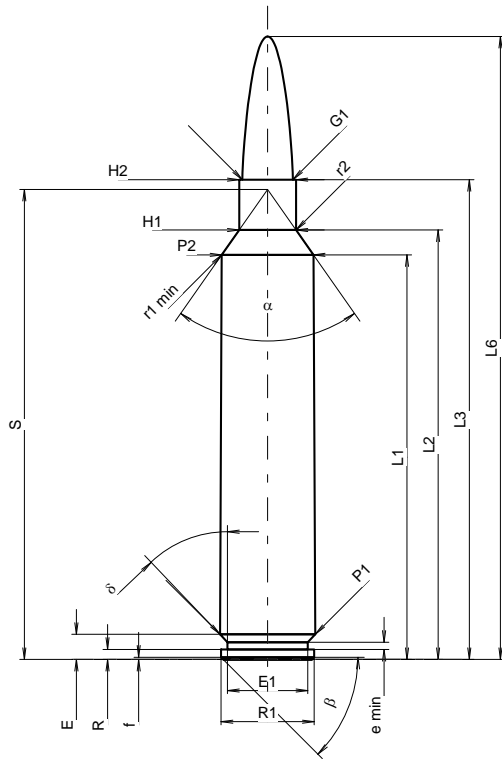

# C.I.P.

# 277 GS

**TAB. I**
**Date 96-11-26**

Country of Origin: IT

**Revision 11-05-25**

**CARTRIDGE MAXI**
**Lengths**

L1 <sup>1)</sup> *	=	56.50	-0.20
L2 <sup>1)</sup> *	=	59.97	-0.20
L3 <sup>1)</sup>	=	67.00	
L4	=		
L5	=		
L6	=	87.00	

**Case Head**

R	=	1.40
R1	=	13.00
R3	=	
E	=	3.50
E1	=	11.20
e min	=	1.00
delta	=	43°40'04"
f	=	0.30
beta	=	45°

**Powder Chamber**

P1	=	13.30	
P2 <sup>1)</sup> *	=	12.80	-0.20

**Junction Cone**

alpha	=	70°
S	=	65.64
r1 min	=	0.50
r2	=	0.50

**Collar**

H1 *	=	7.94
H2 <sup>1)</sup>	=	7.94

**Projectile**

G1 <sup>1)</sup>	=	7.06
G2	=	
F	=	
L3+G <sup>1)</sup>	=	73.00

**Pressures (Energies)**
**Method Transducer**

Pmax	=	4400 bar
PK	=	5060 bar
PE	=	5500 bar
M	=	25.00
EE	=	4883 Joule

**Miscellaneous Dimensions**

Fe <sup>1)3)</sup>	=	0.10
delta L	=	

**CHAMBER MINI**
**Lengths**

L1 *	=	56.48
L2 *	=	59.95
L3 <sup>1)</sup>	=	67.30

**Breech**

R	=	1.40
R1	=	13.05
R2	=	
R3	=	
r	=	

**Powder Chamber**

E	=	3.50
P1 <sup>1)</sup> *	=	13.33
P2	=	12.83

**Junction Cone**

alpha <sup>1)</sup>	=	70°
S	=	65.64
r1 max	=	0.50
r2	=	0.50

**Collar**

H1 *	=	7.98
H2 <sup>1)</sup>	=	7.96

**Commencement of Rifling**

G1 <sup>1)</sup> *	=	7.07
G <sup>1)</sup> *	=	6.00
alpha1	=	180°
h	=	
s	=	
i <sup>1)</sup>	=	1°
w	=	

**Barrel**

F <sup>1)</sup> *	=	6.86
Z <sup>1)</sup>	=	7.04

**Grooves**

b	=	4.06
N	=	4
u	=	254.00
Q	=	38.52 mm <sup>2</sup>

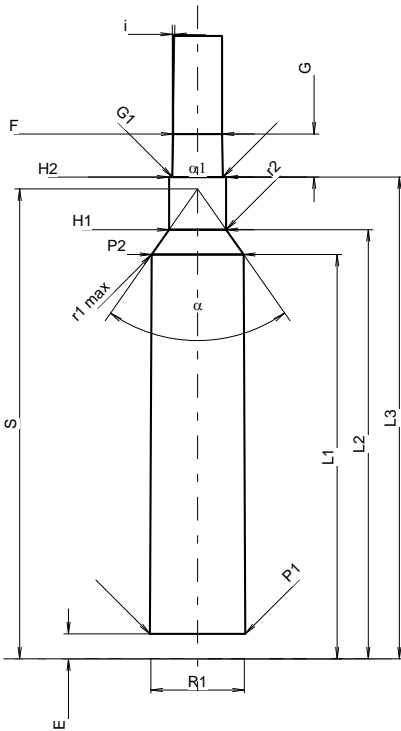

Scale 1:1.06

 Dimensions in << mm >>  
 Dimensions and Tolerances for Proof Barrels  
 see Appendix CR 1.

 Notes: 1) Check for safety reasons  
 3) Headspace on Shoulder  
 \* Basic dimensions