

C.I.P.**28 Nosler****TAB.****I****Date****23-05-09**

Country of Origin: US

Revision**CARTRIDGE MAXI****CHAMBER MINI****Lengths**

L1 1)*	=	55.02	-0.20
L2 1)*	=	58.79	-0.20
L3 1)	=	65.79	
L4	=		
L5	=		
L6	=	84.84	

Lengths

L1 *	=	54.90
L2 *	=	58.65
L3 1)	=	66.04

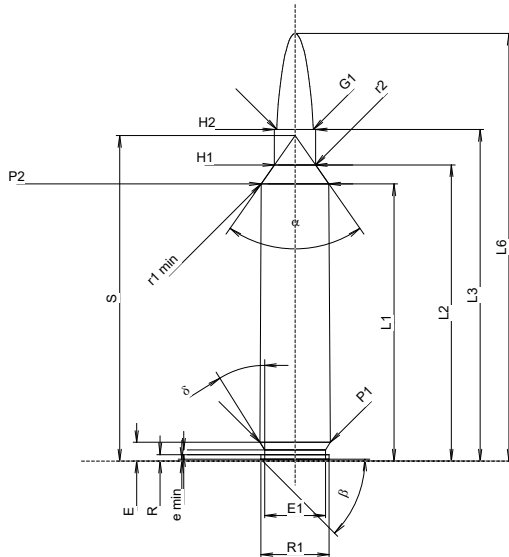
**Case Head**

R	=	1.27
R1	=	13.56
R3	=	
E	=	3.74
E1	=	12.07
e min	=	0.94
delta	=	32°
f	=	0.38
beta	=	45°

Breech

R	=	
R1	=	14.05
R2	=	
R3	=	
r	=	

Powder Chamber

P1	=	13.98
P2 1)*	=	13.40 -0.20

Powder Chamber

E	=	3.74
P1 1)	=	14.00
P2 *	=	13.43

Junction Cone

alpha	=	70°
S	=	64.61
r1 min	=	0.76
r2	=	3.18

Junction Cone

alpha 1)	=	70°
S	=	64.49
r1 max	=	0.76
r2	=	3.18

Collar

H1 *	=	8.13
H2 1)	=	8.13

Collar

H1 *	=	8.18
H2 1)	=	8.18

Projectile

G1 1)	=	7.23
G2	=	
F	=	
L3+G 1)*	=	72.69

Commencement of Rifling

G1 1)*	=	7.23
G 1)*	=	6.90
alpha1	=	90°
h	=	0.47
s *	=	5.08
i 1)	=	3°
w	=	

Pressures (Energies)**Method Transducer**

Pmax	=	4400 bar
PK	=	5060 bar
PE	=	5500 bar
M	=	25.00
EE	=	5500 Joule

Barrel

F 1)*	=	7.04
Z 1)	=	7.21

Grooves

b	=	2.79
N	=	6
u	=	228.60
Q	=	40.39 mm ²

Miscellaneous Dimensions

Fe 1)3)	=	0.10
delta L	=	0.10

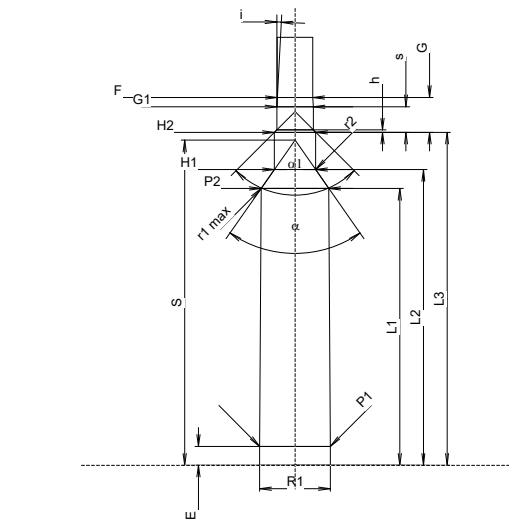

Scale 1:1.5

Dimensions in << mm >>
Dimensions and Tolerances for Proof Barrels
see Appendix CR1.

Notes: 1) Check for safety reasons
3) Headspace on Shoulder
* Basic dimensions