

C.I.P.**28 Nosler**

TAB.

I

Date

23-05-09

Pays d'origine: US

Révision

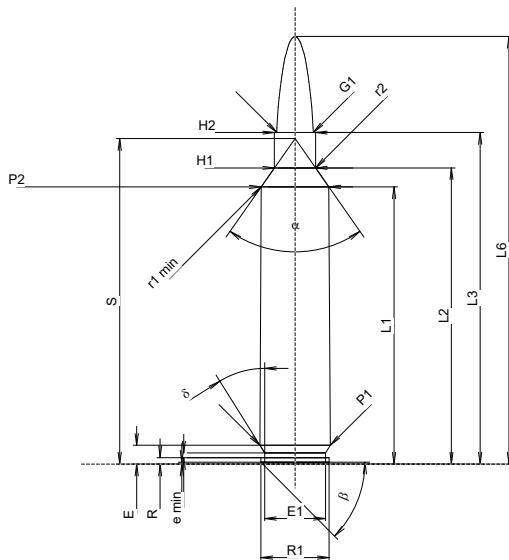
**CARTOUCHE MAXI****Longueurs**

L1 1)*	=	55.02	-0.20
L2 1)*	=	58.79	-0.20
L3 1)	=	65.79	
L4	=		
L5	=		
L6	=	84.84	

Culot

R	=	1.27	
R1	=	13.56	
R3	=		
E	=	3.74	
E1	=	12.07	
e min	=	0.94	
delta	=	32°	
f	=	0.38	
beta	=	45°	

Chambre à poudre

P1	=	13.98	
P2 1)*	=	13.40	-0.20

Cône de raccordement

alpha	=	70°	
S	=	64.61	
r1 min	=	0.76	
r2	=	3.18	

Collet

H1 *	=	8.13	
H2 1)	=	8.13	

Projectile

G1 1)	=	7.23	
G2	=		
F	=		
L3+G 1)*	=	72.69	

Pressions (Énergies)**Méthode transducteur**

Pmax	=	4400 bar	
PK	=	5060 bar	
PE	=	5500 bar	
M	=	25.00	
EE	=	5500 Joule	

Autres indications

Fe 1)3)	=	0.10	
delta L	=	0.10	

CHAMBRE MINI**Longueurs**

L1 *	=	54.90	
L2 *	=	58.65	
L3 1)	=	66.04	

Cuvette

R	=		
R1	=	14.05	
R2	=		
R3	=		
r	=		

Chambre à poudre

E	=	3.74	
P1 1)	=	14.00	
P2 *	=	13.43	

Cône de raccordement

alpha 1)	=	70°	
S	=	64.49	
r1 max	=	0.76	
r2	=	3.18	

Collet

H1 *	=	8.18	
H2 1)	=	8.18	

Prise de rayures

G1 1)*	=	7.23	
G 1)*	=	6.90	
alpha1	=	90°	
h	=	0.47	
s *	=	5.08	
i 1)	=	3°	
w	=		

Canon

F 1)*	=	7.04	
Z 1)	=	7.21	

Rayures

b	=	2.79	
N	=	6	
u	=	228.60	
Q	=	40.39	mm ²

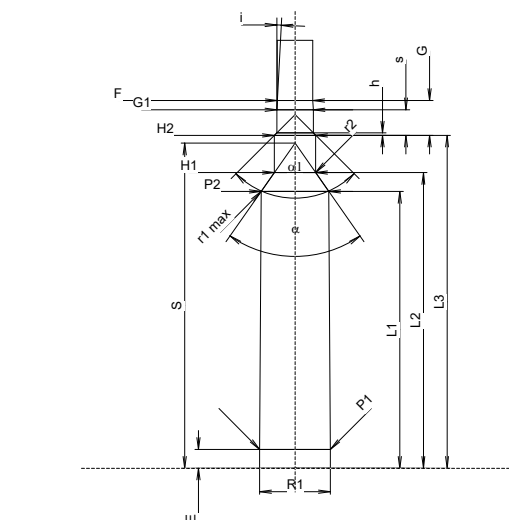

Échelle 1:1.5

Dimensions en << mm >>
Dimensions et tolérances pour les canons
d'épreuve: Voyez Annexe CR1.

Notes: 1) A' contrôler pour la sécurité
3) Feuillure sur la cone de raccordement
* Dimensions de base