

C.I.P.

300 Pegasus

Country of Origin: US

TAB. I

Date 14-05-20

Revision

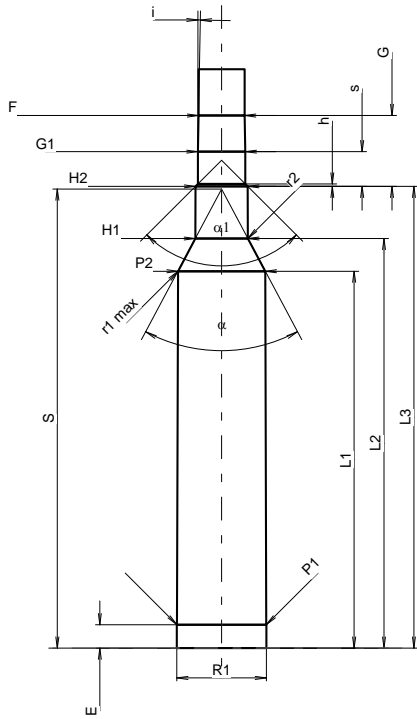
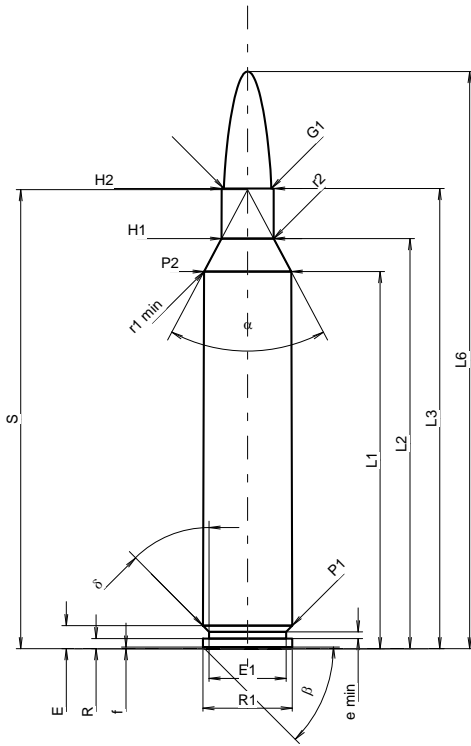

Scale 1:1.25

Dimensions in << mm >>
Dimensions and Tolerances for Proof Barrels
see Appendix CR1.

CARTRIDGE MAXI

Lengths

L1 ¹⁾	=	62.23	-0.20
L2 ¹⁾	=	67.66	-0.20
L3 ¹⁾	=	75.95	
L4	=		
L5	=		
L6	=	95.25	

Case Head

R	=	1.65	
R1	=	14.73	
R3	=		
E	=	3.79	
E1	=	12.70	
e min	=	1.12	
delta	=	45°	
f	=	0.25	
beta	=	45°	

Powder Chamber

P1	=	14.73	
P2 ¹⁾ *	=	14.38	-0.20

Junction Cone

alpha * ¹⁾	=	56°	
S * ¹⁾	=	75.75	
r1 min	=	1.02	
r2	=	3.18	

Collar

H1 * ¹⁾	=	8.61	
H2 ¹⁾	=	8.59	

Projectile

G1 ¹⁾ *	=	7.82	
G2	=		
F	=		
L3+G ¹⁾	=	87.65	

Pressures (Energies)

Method Transducer

Pmax	=	4300 bar	
PK	=	4945 bar	
PE	=	5375 bar	
M	=	25.00	
EE	=	6400 Joule	

Miscellaneous Dimensions

Fe ¹⁾³⁾	=	0.10	
delta L	=		

CHAMBER MINI

Lengths

L1	=	62.20	
L2	=	67.61	
L3 ¹⁾	=	76.20	

Breech

R	=		
R1	=	14.78	
R2	=		
R3	=		
r	=		

Powder Chamber

E	=	3.85	
P1 ¹⁾	=	14.76	
P2 * ¹⁾	=	14.41	

Junction Cone

alpha ¹⁾ * ¹⁾	=	56°	
S * ¹⁾	=	75.75	
r1 max	=	0.76	
r2	=	3.81	

Collar

H1 * ¹⁾	=	8.66	
H2 ¹⁾	=	8.64	

Commencement of Rifling

G1 ¹⁾ *	=	7.85	
G ¹⁾	=	11.70	
alpha l	=	90°	
h	=	0.40	
s * ¹⁾	=	5.72	
i ¹⁾ *	=	1°06'	
w	=		

Barrel

F ¹⁾ *	=	7.62	
Z ¹⁾	=	7.82	

Grooves

b	=	3.00	
N	=	6	
u	=	254.00	
Q	=	47.45	mm ²

Notes: 1) Check for safety reasons
3) Headspace on Shoulder
* Basic dimensions