

# C.I.P.

## 300 Precision Rifle Cartridge

Country of Origin: US

TAB.	I
Date	19-05-22
Revision	20-11-10

Alternative Names: 300 PRC

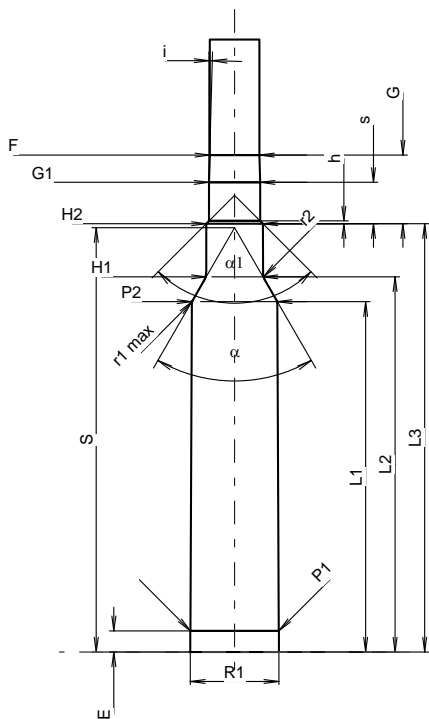
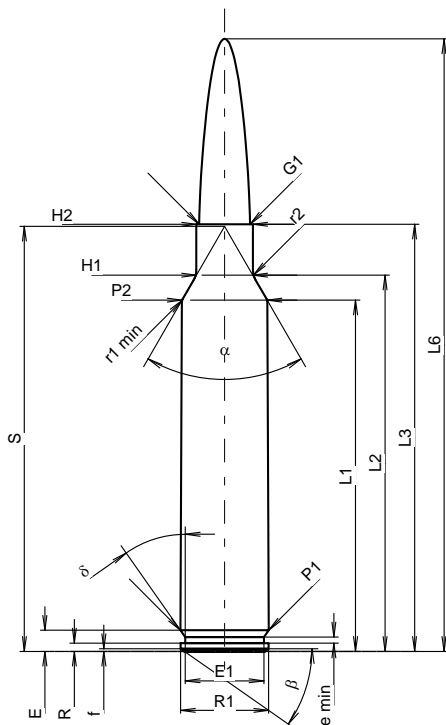

Scale 1:1.16

Dimensions in << mm >>  
Dimensions and Tolerances for Proof Barrels  
see Appendix CR 1.

### CARTRIDGE MAXI

#### Lengths

L1 <sup>1)</sup>	=	53.89	-0.20
L2 <sup>1)</sup>	=	57.72	-0.20
L3 <sup>1)</sup>	=	65.53	
L4	=		
L5	=		
L6	=	93.98	

#### Case Head

R	=	1.27	
R1	=	13.51	
R3	=		
E	=	3.25	
E1	=	12.07	
e min	=	0.94	
delta	=	35°	
f	=	0.41	
beta	=	35°	

#### Powder Chamber

P1	=	13.53	
P2 <sup>1)</sup> *	=	13.08	-0.20

#### Junction Cone

alpha* <sup>1)</sup>	=	60°	
S* <sup>1)</sup>	=	65.22	
r1 min	=	0.76	
r2	=	3.18	

#### Collar

H1* <sup>1)</sup>	=	8.66	
H2 <sup>1)</sup>	=	8.66	

#### Projectile

G1 <sup>1)</sup>	=	7.83	
G2	=		
F	=		
L3+G <sup>1)</sup>	=	76.07	

#### Pressures (Energies)

##### Method Transducer

Pmax	=	4400 bar	
PK	=	5060 bar	
PE	=	5500 bar	
M	=	25.00	
EE	=	5800 Joule	

#### Miscellaneous Dimensions

Fe <sup>1)3)</sup>	=	0.10	
delta L	=	0.11	

### CHAMBER MINI

#### Lengths

L1	=	53.76	
L2	=	57.57	
L3 <sup>1)</sup>	=	65.72	

#### Breech

R	=		
R1	=	13.58	
R2	=		
R3	=		
r	=		

#### Powder Chamber

E	=	3.25	
P1 <sup>1)</sup>	=	13.55	
P2* <sup>1)</sup>	=	13.11	

#### Junction Cone

alpha <sup>1)</sup> *	=	60°	
S* <sup>1)</sup>	=	65.11	
r1 max	=	0.76	
r2	=	3.18	

#### Collar

H1* <sup>1)</sup>	=	8.71	
H2 <sup>1)</sup>	=	8.69	

#### Commencement of Rifling

G1 <sup>1)</sup> *	=	7.84	
G	=	10.54	
alpha l	=	90°	
h	=	0.43	
s* <sup>1)</sup>	=	6.34	
i <sup>1)</sup> *	=	1°30'	
w	=		

#### Barrel

F <sup>1)</sup> *	=	7.62	
Z <sup>1)</sup>	=	7.82	

#### Grooves

b	=	2.92	
N	=	6	
u	=	216.00	
Q	=	47.40	mm <sup>2</sup>

Notes: 1) Check for safety reasons  
3) Headspace on Shoulder  
\* Basic dimensions