

C.I.P.**375 XLR**

TAB. I

Datum 22-04-26

Ursprungsland: DE

Revision

Alternative Namen: 375 Brand, 9,52 x70

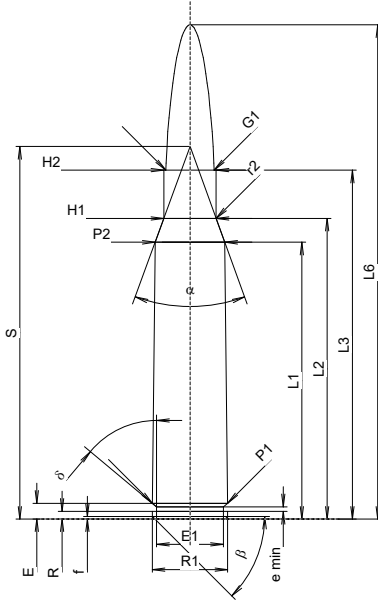
**PATRONE MAXI****Längen**

L1 ¹⁾	=	54.90	-0.20
L2 ¹⁾	=	59.63	-0.20
L3 ¹⁾	=	69.20	
L4	=		
L5	=		
L6	=	98.00	

Hülsenboden

R	=	1.52	
R1	=	14.93	
R3	=		
E	=	3.12	
E1	=	13.24	
e min	=	0.90	
delta	=	50.026111°	
f	=	0.50	
beta	=	45°	

Pulverkammer

P1	=	14.91	
P2 ¹⁾ *	=	13.82	-0.20

Schulterkonus

alpha *	=	39°59'49"	
S *	=	73.90	
r1 min	=		
r2	=	2.00	

Hülsenhals

H1 *	=	10.38	
H2 ¹⁾	=	10.38	

Geschoss

G1 ¹⁾	=	9.55	
G2	=		
F	=		
L3+G ¹⁾	=	75.92	

Drücke (Energien)**Mech. elektr. Wandler**

Pmax	=	4400 bar	
PK	=	5060 bar	
PE	=	5500 bar	
M	=	25.00	
EE	=	8050 Joule	

Verschiedene Daten

Fe ³⁾	=	0.10	
delta L	=	0.14	

PATRONENLAGER MINI**Längen**

L1	=	54.81	
L2	=	59.48	
L3 ¹⁾	=	69.50	

Stoßboden

R	=		
R1	=	15.03	
R2	=		
R3	=		
r	=		

Pulverkammer

E	=	3.12	
P1 ¹⁾	=	14.96	
P2 *	=	13.85	

Schulterkonus

alpha ¹⁾	=	40°00'45"	
S *	=	73.83	
r1 max	=		
r2	=		

Hülsenhals

H1	=	10.45	
H2 ¹⁾	=	10.42	

Geschossübergang

G1 ¹⁾ *	=	9.56	
G ¹⁾	=	6.72	
alpha1 *	=	90°	
h	=	0.43	
s	=	3.00	
i ¹⁾ *	=	2°	
w	=		

Lauf

F ¹⁾ *	=	9.30	
Z ¹⁾	=	9.55	

Züge

b	=	2.92	
N	=	6	
u	=	305.00	
Q	=	70.16	mm ²

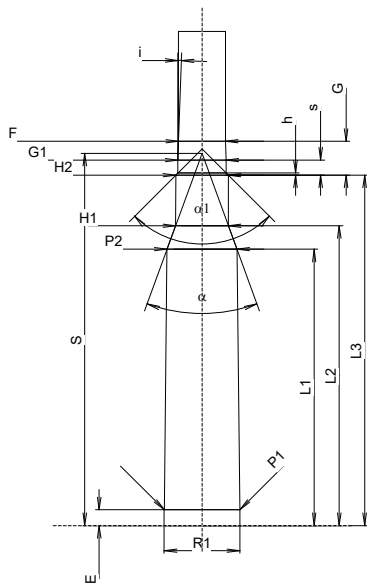

Maßstab 1:1.5

Maße in << mm >>
Maße und Toleranzen für Messläufe
siehe Anhang CR 1.

Bemerkungen: 1) Kontrolle aus Sicherheitsgründen
3) Verschlussabstand an Schulter
* Grundmaße