

C.I.P.**375 XLR**

TAB.

I

Date

22-04-26

Country of Origin: DE

Revision

Alternative Names: 375 Brand, 9,52 x70

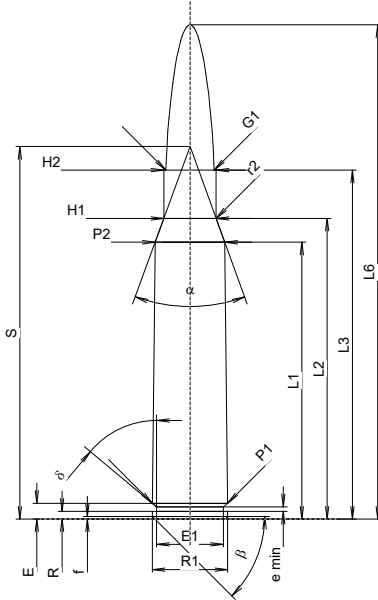
**CARTRIDGE MAXI****Lengths**

L1 ¹⁾	=	54.90	-0.20
L2 ¹⁾	=	59.63	-0.20
L3 ¹⁾	=	69.20	
L4	=		
L5	=		
L6	=	98.00	

Case Head

R	=	1.52	
R1	=	14.93	
R3	=		
E	=	3.12	
E1	=	13.24	
e min	=	0.90	
delta	=	50.026111°	
f	=	0.50	
beta	=	45°	

Powder Chamber

P1	=	14.91	
P2 ¹⁾ *	=	13.82	-0.20

Junction Cone

alpha *	=	39°59'49"	
S *	=	73.90	
r1 min	=		
r2	=	2.00	

Collar

H1 *	=	10.38	
H2 ¹⁾	=	10.38	

Projectile

G1 ¹⁾	=	9.55	
G2	=		
F	=		
L3+G ¹⁾	=	75.92	

Pressures (Energies)**Method Transducer**

Pmax	=	4400 bar	
PK	=	5060 bar	
PE	=	5500 bar	
M	=	25.00	
EE	=	8050 Joule	

Miscellaneous Dimensions

Fe ³⁾	=	0.10	
delta L	=	0.14	

CHAMBER MINI**Lengths**

L1	=	54.81	
L2	=	59.48	
L3 ¹⁾	=	69.50	

Breech

R	=		
R1	=	15.03	
R2	=		
R3	=		
r	=		

Powder Chamber

E	=	3.12	
P1 ¹⁾	=	14.96	
P2 *	=	13.85	

Junction Cone

alpha ¹⁾	=	40°00'45"	
S *	=	73.83	
r1 max	=		
r2	=		

Collar

H1	=	10.45	
H2 ¹⁾	=	10.42	

Commencement of Rifling

G1 ¹⁾ *	=	9.56	
G ¹⁾	=	6.72	
alpha1 *	=	90°	
h	=	0.43	
s	=	3.00	
i ¹⁾ *	=	2°	
w	=		

Barrel

F ¹⁾ *	=	9.30	
Z ¹⁾	=	9.55	

Grooves

b	=	2.92	
N	=	6	
u	=	305.00	
Q	=	70.16	mm ²

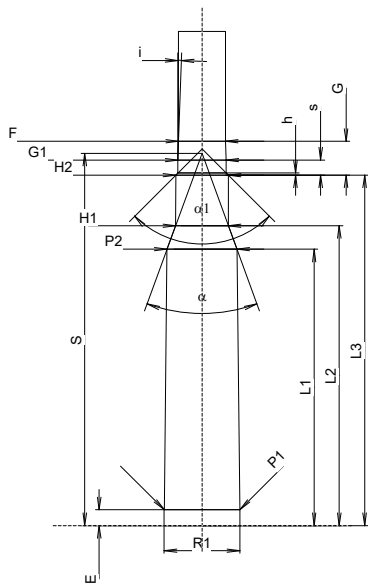

Scale 1:1.5

Dimensions in << mm >>
Dimensions and Tolerances for Proof Barrels
see Appendix CR 1.

Notes: 1) Check for safety reasons
3) Headspace on Shoulder
* Basic dimensions