

C.I.P.

400 Legend

Country of Origin: US

TAB.

I

Date

23-11-08

Revision

Alternative Names: 400 LGND

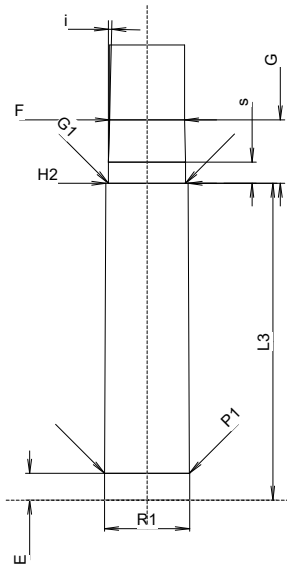
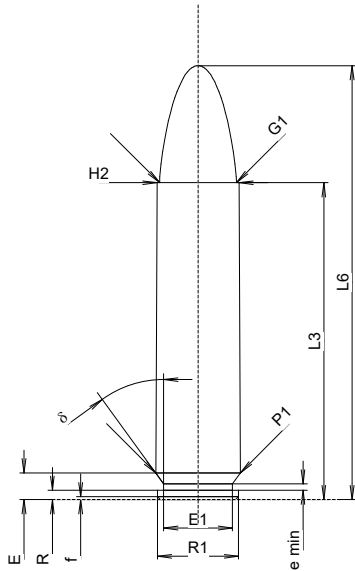

Scale 1:1

Dimensions in << mm >>
Dimensions and Tolerances for Proof Barrels
see Appendix 1.

CARTRIDGE MAXI

Lengths

L1	=		
L2	=		
L3 ¹⁾	=	41.91	-0.25
L4	=		
L5	=		
L6	=	57.40	

Case Head

R	=	1.24	
R1	=	10.72	
R3	=		
E	=	3.53	
E1	=	9.09	
e min	=	0.84	
delta	=	36°	
f	=	0.38	
beta	=	0°	

Powder Chamber

P1	=	11.19	
P2	=		

Junction Cone

alpha	=		
S	=		
r1 min	=		
r2	=		

Collar

H1	=		
H2 ¹⁾	=	10.84	

Projectile

G1 ¹⁾	=	10.17	
G2	=		
F	=		
L3+G ¹⁾	=	50.28	

Pressures (Energies)

Method Transducer

Pmax	=	3180 bar	
PK	=	3657 bar	
PE	=	3975 bar	
M	=		
EE	=	3200 Joule	

Miscellaneous Dimensions

Fe	=	0.15	
delta L	=		

CHAMBER MINI

Lengths

L1	=		
L2	=		
L3 ¹⁾	=	41.91	

Breech

R	=		
R1	=	11.25	
R2	=		
R3	=		
r	=		

Powder Chamber

E	=	3.53	
P1 ¹⁾	=	11.21	
P2	=		

Junction Cone

alpha	=		
S	=		
r1 max	=		
r2	=		

Collar

H1	=		
H2 ¹⁾	=	10.86	

Commencement of Rifling

G1 ¹⁾ *	=	10.20	
G ¹⁾ *	=	8.37	
alpha1	=		
h	=		
s *	=	2.79	
i ¹⁾ *	=	1°30'	
w	=		

Barrel

F ¹⁾ *	=	9.91	
Z ¹⁾	=	10.17	

Grooves

b	=	3.05	
N	=	6	
u	=	406.40	mm ²
Q	=	79.55	mm ²

Notes: 1) Check for safety reasons
* Basic dimensions