

**C.I.P.****416 A-TEC**

TAB.

I

Date

16-05-18

Country of Origin: NO

Revision

Alternative Names: 416 A-SUB

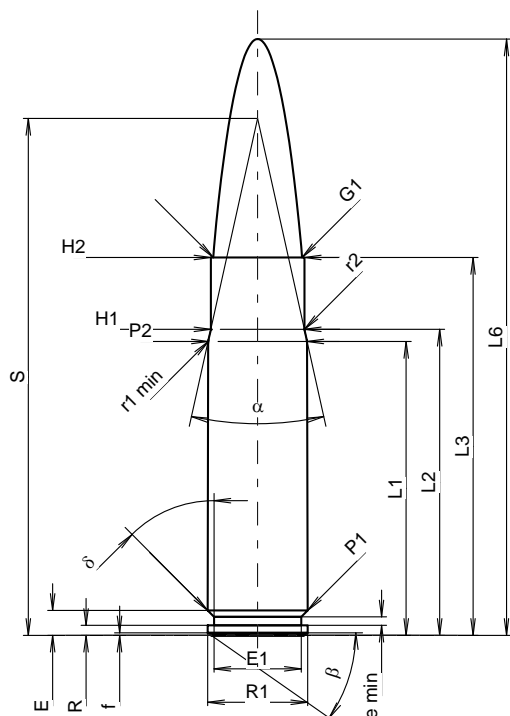
**CARTRIDGE MAXI****Lengths**

L1 <sup>1)</sup>	=	35.00	-0.20
L2 <sup>1)</sup>	=	36.44	-0.20
L3 <sup>1)</sup>	=	45.00	
L4	=		
L5	=		
L6	=	71.00	

**Case Head**

R	=	1.20	
R1	=	11.90	
R3	=		
E	=	2.97	
E1	=	10.39	
e min	=	1.00	
delta	=	45°	
f	=	0.30	
beta	=	35°	

**Powder Chamber**

P1	=	11.92	
P2 <sup>1)</sup> *	=	11.77	-0.20

**Junction Cone**

alpha <sup>*</sup>	=	25°	
S <sup>*</sup>	=	61.54	
r1 min	=	2.00	
r2	=	0.50	

**Collar**

H1 <sup>*</sup>	=	11.13	
H2 <sup>1)</sup>	=	11.13	

**Projectile**

G1 <sup>1)</sup>	=	10.57	
G2	=		
F	=		
L3+G <sup>1)</sup>	=	52.79	

**Pressures (Energies)****Method Transducer**

Pmax	=	4150 bar	
PK	=	4773 bar	
PE	=	5188 bar	
M	=	25.00	
EE	=	3000 Joule	

**Miscellaneous Dimensions**

Fe <sup>1)3)</sup>	=	0.10	
delta L	=		

**CHAMBER MINI****Lengths**

L1	=	35.00	
L2	=	36.40	
L3 <sup>1)</sup>	=	45.20	

**Breech**

R	=		
R1	=	11.95	
R2	=		
R3	=		
r	=	1.00	

**Powder Chamber**

E	=	3.50	
P1 <sup>1)</sup>	=	11.95	
P2 <sup>*</sup>	=	11.80	

**Junction Cone**

alpha <sup>1)</sup> *	=	25°	
S <sup>*</sup>	=	61.61	
r1 max	=	2.00	
r2	=	0.50	

**Collar**

H1 <sup>*</sup>	=	11.18	
H2 <sup>1)</sup>	=	11.15	

**Commencement of Rifling**

G1 <sup>1)</sup> *	=	10.58	
G <sup>1)</sup>	=	7.79	
alpha l	=	60°	
h	=	0.49	
s <sup>*</sup>	=	3.59	
i <sup>1)</sup> *	=	1°30'	
w	=		

**Barrel**

F <sup>1)</sup> *	=	10.36	
Z <sup>1)</sup>	=	10.57	

**Grooves**

b	=	3.25	
N	=	6	
u	=	356.00	
Q	=	86.38	mm <sup>2</sup>

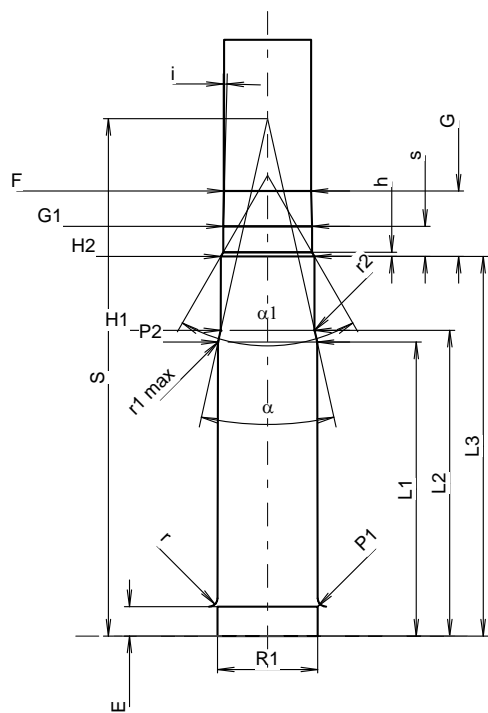

Scale 1.11:1

Dimensions in << mm >>  
Dimensions and Tolerances for Proof Barrels  
see Appendix CR 1.

Notes: 1) Check for safety reasons  
3) Headspace on Shoulder  
\* Basic dimensions