

C.I.P.

416 Barrett

Country of Origin: US

TAB.

I

Date

16-05-18

Revision

13-05-25

Alternative Names: 10,4 x 83

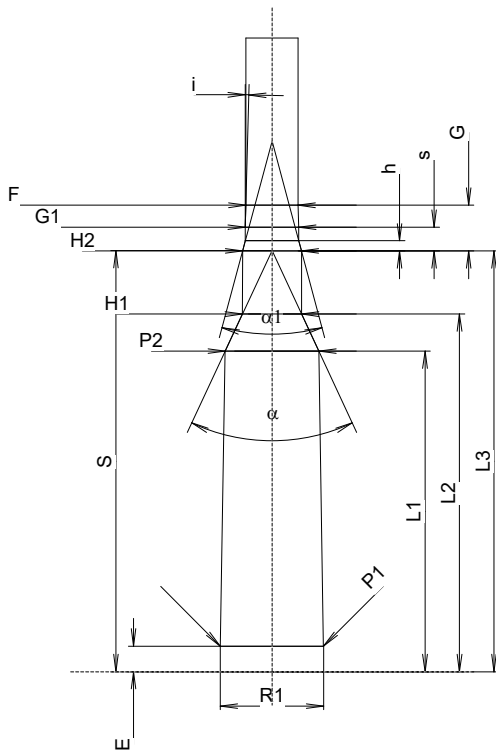
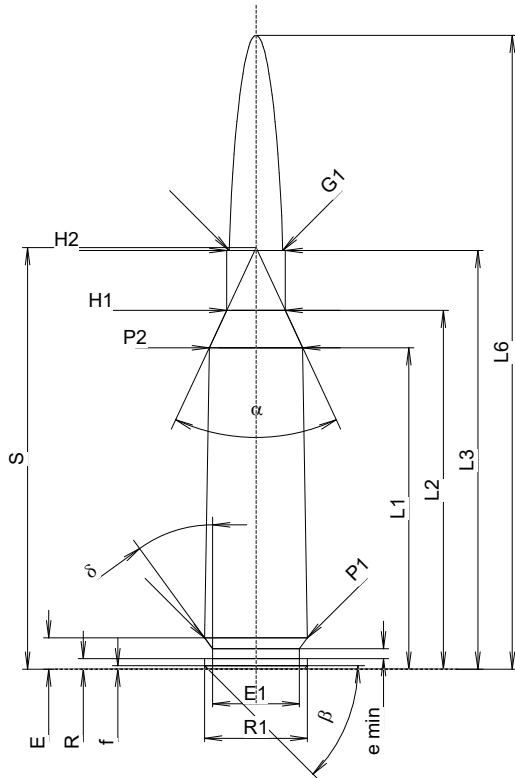

Scale 1:1.5

Dimensions in << mm >>
Dimensions and Tolerances for Proof Barrels
see Appendix CR1.

CARTRIDGE MAXI

Lengths

L1 ¹⁾	=	63.74	-0.20
L2 ¹⁾	=	71.15	-0.20
L3 ¹⁾	=	83.06	
L4	=		
L5	=		
L6	=	125.73	

Case Head

R	=	2.11	
R1	=	20.42	
R3	=		
E	=	6.22	
E1	=	17.27	
e min	=	1.96	
delta	=	36°	
f	=	0.69	
beta	=	45°	

Powder Chamber

P1	=	20.40	
P2 ¹⁾ *	=	18.54	-0.20

Junction Cone

alpha *	=	50°	
S *	=	83.62	
r1 min	=		
r2	=		

Collar

H1 *	=	11.63	
H2 ¹⁾	=	11.63	

Projectile

G1 ¹⁾	=	10.57	
G2	=		
F	=		
L3+G ¹⁾	=	92.15	

Pressures (Energies)

Method Transducer

Pmax	=	4400 bar	
PK	=	5060 bar	
PE	=	5500 bar	
M	=	25.00	
EE	=	14250 Joule	

Miscellaneous Dimensions

Fe ¹⁾³⁾	=	0.10	
delta L	=	0.10	

CHAMBER MINI

Lengths

L1	=	63.61	
L2	=	70.94	
L3 ¹⁾	=	83.44	

Breech

R	=		
R1	=	20.52	
R2	=		
R3	=		
r	=		

Powder Chamber

E	=	5.08	
P1 ¹⁾	=	20.45	
P2 *	=	18.57	

Junction Cone

alpha ¹⁾ *	=	50°	
S *	=	83.52	
r1 max	=		
r2	=		

Collar

H1 *	=	11.73	
H2 ¹⁾	=	11.68	

Commencement of Rifling

G1 ¹⁾ *	=	10.59	
G ¹⁾	=	9.09	
alpha1	=	30°	
h	=	2.03	
s *	=	4.70	
i ¹⁾ *	=	1°30'	
w	=		

Barrel

F ¹⁾ *	=	10.36	
Z ¹⁾	=	10.57	

Grooves

b	=	4.11	
N	=	6	
u	=	304.80	
Q	=	86.96	mm ²

Notes: 1) Check for safety reasons
3) Headspace on Shoulder
* Basic dimensions