

C.I.P.

7,92 x 33 kurz

Country of Origin: DE

TAB. I

Date 84-06-14

Revision 14-05-20

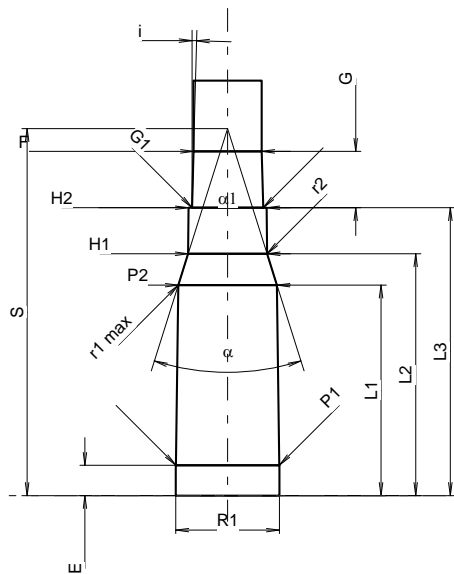
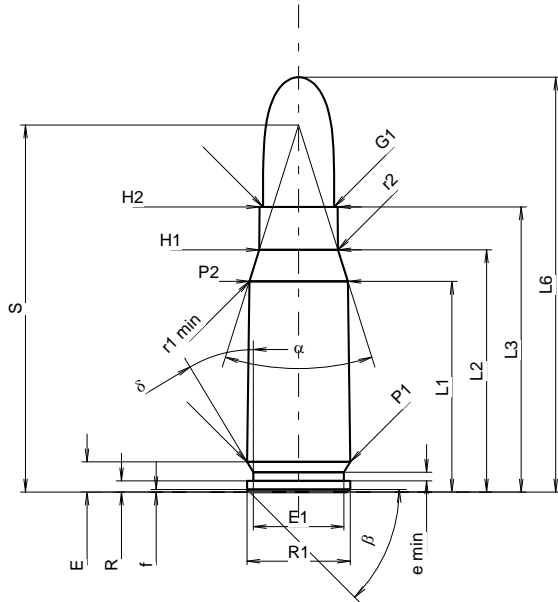

Scale 1.14:1

Dimensions in << mm >>
Dimensions and Tolerances for Proof Barrels
see Appendix .

CARTRIDGE MAXI

Lengths

L1 *	=	24.38	-0.20
L2 *	=	28.03	-0.20
L3 ¹⁾	=	33.00	
L4	=		
L5	=		
L6	=	48.00	

Case Head

R	=	1.30	
R1	=	11.95	
R3	=		
E	=	3.50	
E1	=	10.50	
e min	=	1.00	
delta	=	31°	
f	=	0.30	
beta	=	45°	

Powder Chamber

P1	=	11.94	
P2 ¹⁾ *	=	11.40	-0.20

Junction Cone

alpha	=	34°58'34"	
S	=	42.47	
r1 min	=	0.50	
r2	=	0.50	

Collar

H1 *	=	9.10	
H2 ¹⁾	=	9.04	

Projectile

G1 ¹⁾	=	8.22	
G2	=		
F	=		
L3+G ¹⁾	=	39.53	

Pressures (Energies)

Method Transducer

Pmax	=	3400 bar	
PK	=	3910 bar	
PE	=	4250 bar	
M	=	17.50	
EE	=	1770 Joule	

Miscellaneous Dimensions

Fe ¹⁾³⁾	=	0.15	
delta L	=		

CHAMBER MINI

Lengths

L1 *	=	24.35	
L2 *	=	27.98	
L3 ¹⁾	=	33.30	

Breech

R	=	1.30	
R1	=	12.00	
R2	=		
R3	=		
r	=		

Powder Chamber

E	=	3.50	
P1 ¹⁾	=	11.97	
P2 *	=	11.42	

Junction Cone

alpha ¹⁾	=	35°00'48"	
S	=	42.45	
r1 max	=	0.50	
r2	=	0.50	

Collar

H1 *	=	9.13	
H2 ¹⁾	=	9.05	

Commencement of Rifling

G1 ¹⁾ *	=	8.24	
G ¹⁾ *	=	6.53	
alpha l	=	180°	
h	=		
s	=		
i ¹⁾	=	1°32'7"	
w	=		

Barrel

F ¹⁾ *	=	7.89	
Z ¹⁾	=	8.20	

Grooves

b	=	4.40	
N	=	4	
u	=	240.00	
Q	=	51.78	mm ²

Notes: 1) Check for safety reasons
3) Headspace on Shoulder
* Basic dimensions