

**C.I.P.****6,5 x 64**

TAB. I

Datum 92-02-27

Revision 02-05-15

Ursprungsland: DE

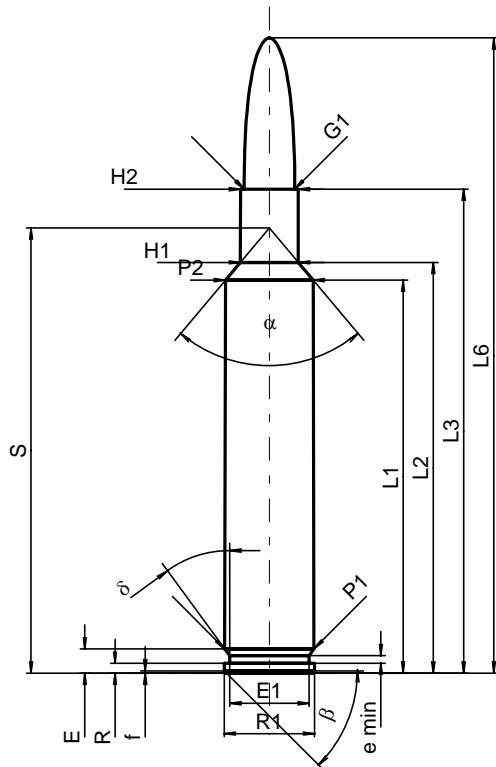
**PATRONE MAXI****Längen**

L1 <sup>1)*</sup>	=	51.97	-0.20
L2 <sup>1)*</sup>	=	54.32	-0.20
L3 <sup>1)</sup>	=	64.00	
L4	=		
L5	=		
L6	=	84.00	

**Hülsenboden**

R	=	1.30	
R1	=	11.95	
R3	=		
E	=	3.20	
E1	=	10.50	
e min	=	1.00	
delta	=	36°15'	
f	=	0.30	
beta	=	45°	

**Pulverkammer**

P1	=	11.82	
P2 <sup>1)*</sup>	=	11.60	-0.20

**Schulterkonus**

alpha	=	80°05'21"	
S	=	58.87	
r1 min	=		
r2	=		

**Hülsenhals**

H1*	=	7.65	
H2 <sup>1)</sup>	=	7.64	

**Geschoss**

G1 <sup>1)</sup>	=	6.70	
G2	=		
F	=		
L3+G <sup>1)</sup>	=	72.00	

**Drücke (Energien)****Mech. elektr. Wandler**

Pmax	=	4300 bar	
PK	=	4945 bar	
PE	=	5375 bar	
M	=	25.00	
EE	=	3645 Joule	

**Verschiedene Daten**

Fe <sup>1)</sup>	=	0.10	
delta L	=		

**PATRONELAGER MINI****Längen**

L1*	=	51.95	
L2*	=	54.30	
L3 <sup>1)</sup>	=	64.30	

**Stoßboden**

R	=	1.30	
R1	=	12.00	
R2	=		
R3	=		
r	=		

**Pulverkammer**

E	=	3.20	
P1 <sup>1)</sup>	=	11.84	
P2*	=	11.63	

**Schulterkonus**

alpha <sup>1)</sup>	=	80°05'21"	
S	=	58.87	
r1 max	=		
r2	=		

**Hülsenhals**

H1*	=	7.68	
H2 <sup>1)</sup>	=	7.67	

**Geschossübergang**

G1 <sup>1)*</sup>	=	6.72	
G <sup>1)*</sup>	=	8.00	
alpha1	=	180°	
h	=		
s	=		
i <sup>1)</sup>	=	0°58'	
w	=		

**Lauf**

F <sup>1)*</sup>	=	6.45	
Z <sup>1)</sup>	=	6.70	

**Züge**

b	=	3.60	
N	=	4	
u	=	228.00	
Q	=	34.58	mm <sup>2</sup>

Maßstab 1:1

Maße in << mm >>  
Maße und Toleranzen für Messläufe  
siehe Anhang CR 1.

Bemerkungen: 1) Kontrolle aus Sicherheitsgründen  
\* Grundmaße