

C.I.P.

7,62 UKM

Ursprungsland: DE

TAB. I

Datum 02-01-22

Revision 08-09-23

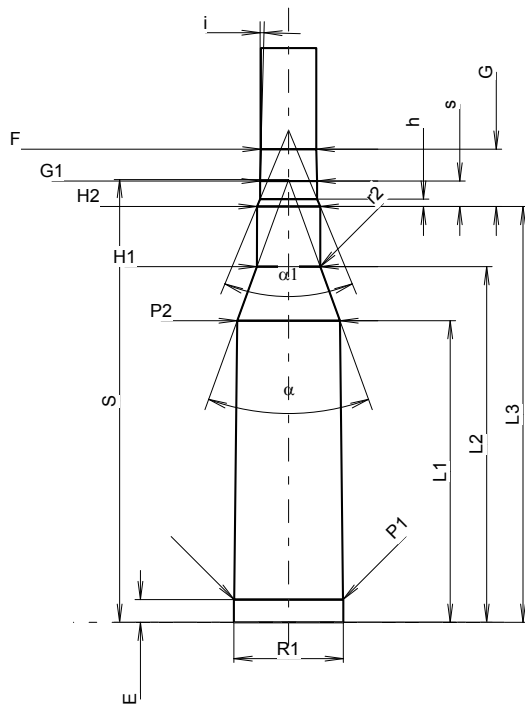
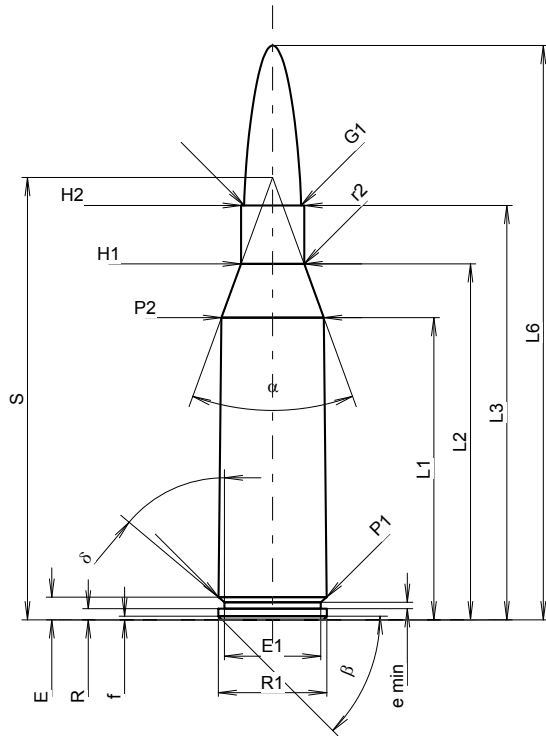

Maßstab 1:1.04

Maße in << mm >>
Maße und Toleranzen für Messläufe
siehe Anhang CR 1.

PATRONE MAXI

Längen

L1 ¹⁾ *	=	41.57	-0.20
L2 ¹⁾ *	=	48.96	-0.20
L3 ¹⁾	=	57.00	
L4	=		
L5	=		
L6	=	79.00	

Hülsenboden

R	=	1.52	
R1	=	14.93	
R3	=		
E	=	3.12	
E1	=	13.24	
e min	=	0.90	
δ	=	50°01'33"	
f	=	0.50	
β	=	45°	

Pulverkammer

P1	=	14.91	
P2 ¹⁾ *	=	14.08	-0.20

Schulterkonus

α	=	40°08'26"	
S	=	60.84	
r1 min	=		
r2	=	2.00	

Hülsenhals

H1 *	=	8.68	
H2 ¹⁾	=	8.68	

Geschoss

G1 ¹⁾	=	7.85	
G2	=		
F	=		
L3+G ¹⁾	=	64.89	

Drücke (Energien)

Mech. elektr. Wandler

Pmax	=	4400 bar	
PK	=	5060 bar	
PE	=	5500 bar	
M	=	25.00	
EE	=	5565 Joule	

Verschiedene Daten

Fe ¹⁾³⁾	=	0.10	
delta L	=		

PATRONENLAGER MINI

Längen

L1 *	=	41.50	
L2 *	=	48.93	
L3 ¹⁾	=	57.20	

Stoßboden

R	=		
R1	=	15.03	
R2	=		
R3	=		
r	=		

Pulverkammer

E	=	3.12	
P1 ¹⁾	=	14.96	
P2 *	=	14.13	

Schulterkonus

α ¹⁾	=	40°00'33"	
S	=	60.91	
r1 max	=		
r2	=	2.50	

Hülsenhals

H1 *	=	8.72	
H2 ¹⁾	=	8.70	

Geschossübergang

G1 ¹⁾ *	=	7.85	
G ¹⁾ *	=	7.89	
α 1	=	45°	
h	=	1.03	
s *	=	3.50	
i ¹⁾	=	1°30'02"	
w	=		

Lauf

F ¹⁾ *	=	7.62	
Z ¹⁾	=	7.82	

Züge

b	=	2.79	
N	=	6	
u	=	254.00	
Q	=	47.32	mm ²

Bemerkungen: 1) Kontrolle aus Sicherheitsgründen
3) Verschlussabstand an Schulter
* Grundmaße