

C.I.P.

275 H. V. Rigby

Country of Origin: GB

TAB. I

Date 84-06-14

Revision 02-05-15

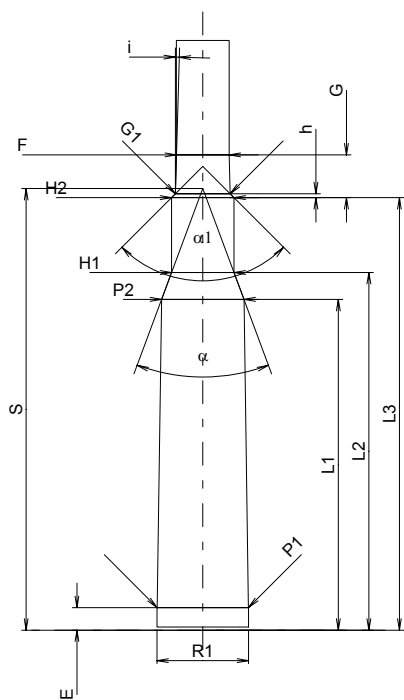
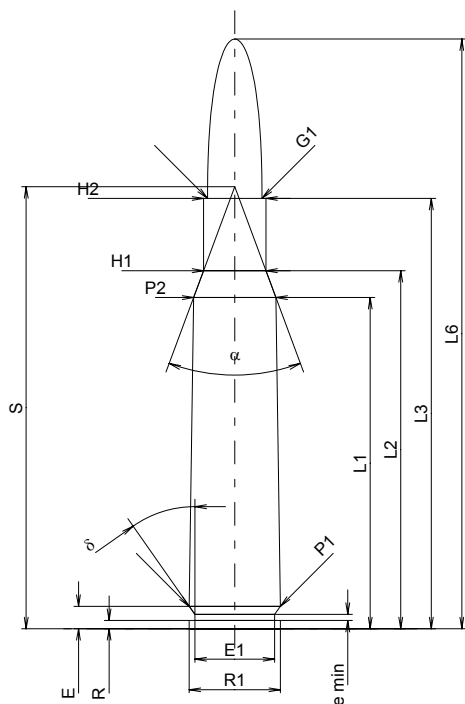

Scale 1:1

Dimensions in << mm >>
Dimensions and Tolerances for Proof Barrels
see Appendix CR 1.**CARTRIDGE MAXI****Lengths**

L1 ¹⁾	=	43.79	-0.20
L2 ¹⁾	=	47.35	-0.20
L3 ¹⁾	=	56.90	
L4	=		
L5	=		
L6	=	77.98	

Case Head

R	=	1.09	
R1	=	12.06	
R3	=		
E	=	2.97	
E1	=	10.54	
e min	=	0.81	
delta	=	35°01'48"	
f	=		
beta	=		

Powder Chamber

P1	=	12.04	
P2 ¹⁾ *	=	10.87	-0.20

Junction Cone

alpha	=	40°41'17"	
S	=	58.45	
r1 min	=		
r2	=		

Collar

H1*	=	8.23	
H2 ¹⁾	=	8.23	

Projectile

G1 ¹⁾	=	7.21	
G2	=		
F	=		
L3+G ¹⁾	=	62.55	

Pressures (Energies)**Method Transducer**

Pmax	=	3200 bar	
PK	=	3680 bar	
PE	=	4000 bar	
M	=	25.00	
EE	=	2720 Joule	

Miscellaneous Dimensions

Fe ¹⁾	=	0.15	
delta L	=		

CHAMBER MINI**Lengths**

L1*	=	43.74	
L2*	=	47.29	
L3 ¹⁾	=	57.20	

Breech

R	=	1.09	
R1	=	12.12	
R2	=		
R3	=		
r	=		

Powder Chamber

E	=	2.97	
P1 ¹⁾	=	12.07	
P2*	=	10.90	

Junction Cone

alpha ¹⁾	=	40°47'34"	
S	=	58.40	
r1 max	=		
r2	=		

Collar

H1*	=	8.26	
H2 ¹⁾	=	8.26	

Commencement of Rifling

G1 ¹⁾ *	=	7.26	
G ¹⁾ *	=	5.65	
alpha 1	=	90°	
h*	=	0.50	
s	=		
i ¹⁾	=	1°36'46"	
w	=		

Barrel

F ¹⁾ *	=	6.97	
Z ¹⁾	=	7.25	

Grooves

b	=	3.62	
N	=	4	
u	=	203.00	
Q	=	40.28	mm ²

Notes: 1) Check for safety reasons
* Basic dimensions