

# C.I.P.

## 8 x 57 PCC

Country of Origin: IT

TAB. I

Date 09-05-05

Revision

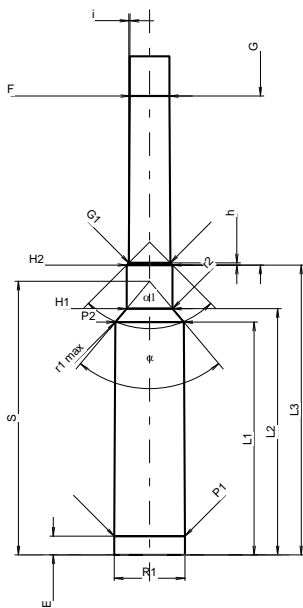
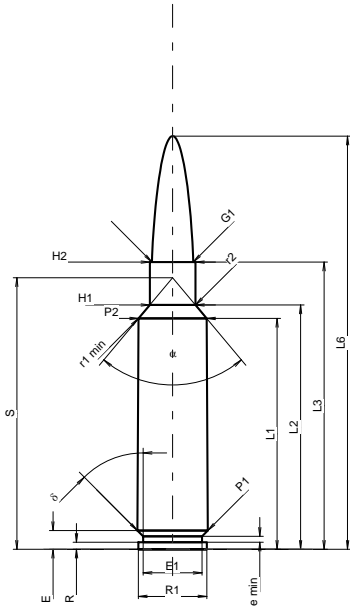

Scale 1:1.5

Dimensions in << mm >>  
Dimensions and Tolerances for Proof Barrels  
see Appendix CR 1.

### CARTRIDGE MAXI

#### Lengths

L1 <sup>1)</sup>	=	45.82	-0.20
L2 <sup>1)</sup>	=	48.49	-0.20
L3 <sup>1)</sup>	=	57.00	
L4	=		
L5	=		
L6	=	82.00	

#### Case Head

R	=	1.40	
R1	=	13.60	
R3	=		
E	=	3.74	
E1	=	11.70	
e min	=	1.20	
delta	=	45°	
f	=		
beta	=		

#### Powder Chamber

P1	=	13.97	
P2 <sup>1)</sup> *	=	13.53	-0.20

#### Junction Cone

alpha *	=	79°51'50"	
S *	=	53.90	
r1 min	=	1.30	
r2	=	1.52	

#### Collar

H1 *	=	9.06	
H2 <sup>1)</sup>	=	9.05	

#### Projectile

G1 <sup>1)</sup>	=	8.20	
G2	=		
F	=		
L3+G <sup>1)</sup>	=	90.54	

#### Pressures (Energies)

#### Method Transducer

Pmax	=	4400 bar	
PK	=	5060 bar	
PE	=	5500 bar	
M	=	25.00	
EE	=	5200 Joule	

#### Miscellaneous Dimensions

Fe <sup>1)3)</sup>	=	0.10	
delta L	=		

### CHAMBER MINI

#### Lengths

L1	=	46.17	
L2	=	48.84	
L3 <sup>1)</sup>	=	57.51	

#### Breech

R	=	1.40	
R1	=	14.00	
R2	=		
R3	=		
r	=		

#### Powder Chamber

E	=	3.71	
P1 <sup>1)</sup>	=	14.00	
P2 *	=	13.60	

#### Junction Cone

alpha <sup>1)</sup> *	=	80°06'57"	
S *	=	54.26	
r1 max	=	1.30	
r2	=	1.52	

#### Collar

H1 *	=	9.11	
H2 <sup>1)</sup>	=	9.10	

#### Commencement of Rifling

G1 <sup>1)</sup> *	=	8.24	
G <sup>1)</sup>	=	33.54	
alpha l	=	90°	
h *	=	0.43	
s	=		
i <sup>1)</sup> *	=	0°18'10"	
w	=		

#### Barrel

F <sup>1)</sup> *	=	7.89	
Z <sup>1)</sup>	=	8.20	

#### Grooves

b	=	4.40	
N	=	4	
u	=	240.00	
Q	=	51.78	mm <sup>2</sup>

Notes: 1) Check for safety reasons  
3) Headspace on Shoulder  
\* Basic dimensions