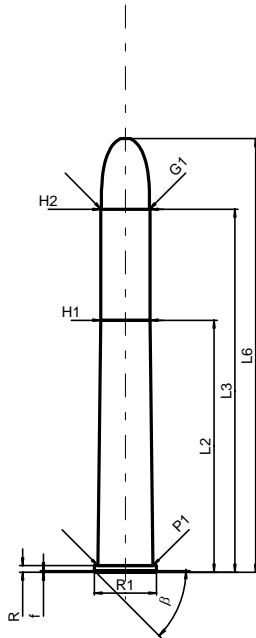

C.I.P.**9,3 x 72 R**

Ursprungsland: DE

TAB. II**Datum 84-06-14****Revision 02-05-15****PATRONE MAXI****Längen**

L1	=	
L2*	=	50.00
L3 ¹⁾	=	72.00
L4	=	
L5	=	
L6	=	86.00

Hülsenboden

R ¹⁾	=	1.30	-0.25
R1	=	12.35	
R3	=		
E	=		
E1	=		
e min	=		
delta	=		
f	=	0.30	
beta	=	45°	

Pulverkammer

P1	=	10.91
P2	=	

Schulterkonus

alpha	=	
S	=	
r1 min	=	
r2	=	

Hülsenhals

H1*	=	9.82
H2 ¹⁾	=	9.82

Geschoss

G1 ¹⁾	=	9.57
G2	=	
F	=	
L3+G ¹⁾	=	99.00

Drücke (Energien)**Mech. elektr. Wandler**

Pmax	=	2000 bar
PK	=	2300 bar
PE	=	2500 bar
M	=	25.00
EE	=	2325 Joule

Verschiedene Daten

Fe ¹⁾	=	0.15
delta L	=	

PATRONENLAGER MINI**Längen**

L1	=	
L2*	=	50.00
L3 ¹⁾	=	72.30

Stoßboden

R ¹⁾	=	1.30
R1	=	12.40
R2	=	
R3	=	
r	=	

Pulverkammer

E	=	
P1 ¹⁾	=	10.93
P2	=	

Schulterkonus

alpha	=	
S	=	
r1 max	=	
r2	=	

Hülsenhals

H1*	=	9.84
H2 ¹⁾	=	9.83

Geschossübergang

G1 ^{1)*}	=	9.65
G ^{1)*}	=	27.00
alpha1	=	180°
h	=	
s	=	
i ¹⁾	=	0°57'17"
w	=	

Lauf

F ^{1)*}	=	8.75
Z ¹⁾	=	9.25

Züge

b	=	4.60
N	=	4
u	=	420.00
Q	=	64.96 mm ²

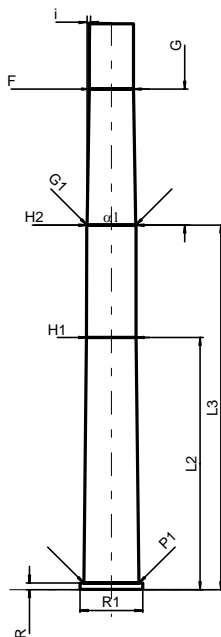

Maßstab 1:1.5

Maße in << mm >>
Maße und Toleranzen für Messläufe
siehe Anhang CR 1.

Bemerkungen: 1) Kontrolle aus Sicherheitsgründen
* Grundmaße