

C.I.P.**308 Norma Mag.**

TAB. III

Date 84-06-14

Révision 16-10-18

Pays d'origine: SE

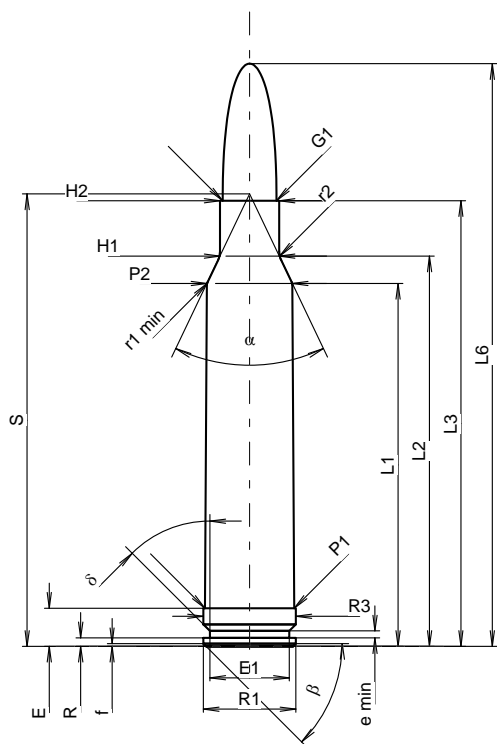
**CARTOUCHE MAXI****Longueurs**

L1	=	52.94
L2	=	56.92
L3 ¹⁾	=	65.00
L4	=	
L5	=	
L6	=	85.00

Culot

R	=	1.25
R1	=	13.50
R3	=	13.50
E ¹⁾	=	5.56
E1	=	11.60
e min	=	1.00
delta	=	45°
f	=	0.40
beta	=	45°

Chambre à poudre

P1	=	13.03
P2 *	=	12.45

Cône de raccordement

alpha *	=	51°
S *	=	65.99
r1 min	=	1.00
r2	=	3.00

Collet

H1 *	=	8.65
H2 ¹⁾	=	8.65

Projectile

G1 ¹⁾	=	7.85
G2	=	
F	=	
L3+G ¹⁾	=	74.65

Pressions (Énergies)**Méthode veyducteur**

Pmax	=	4400 bar
PK	=	5060 bar
PE	=	5500 bar
M	=	25.00
EE	=	4935 Joule

Autres indications

Fe ¹⁾	=	0.10
delta L	=	

CHAMBRE MINI**Longueurs**

L1	=	53.22
L2	=	57.03
L3 ¹⁾	=	65.58

Cuvette

R	=	
R1	=	13.75
R2	=	
R3	=	13.75
r	=	

Chambre à poudre

E ¹⁾	=	5.58
P1 ¹⁾	=	13.06
P2 *	=	12.52

Cône de raccordement

alpha *	=	52°
S *	=	66.05
r1 max	=	2.00
r2	=	3.60

Collet

H1 *	=	8.80
H2 ¹⁾	=	8.75

Prise de rayures

G1 ¹⁾ *	=	7.89
G ¹⁾	=	9.65
alpha1 *	=	90°
h	=	0.43
s	=	
i ¹⁾ *	=	0°50'20"
w	=	

Canon

F ¹⁾ *	=	7.62
Z ¹⁾	=	7.82

Rayures

b	=	4.47
N	=	4
u	=	254.00
Q	=	47.51 mm ²

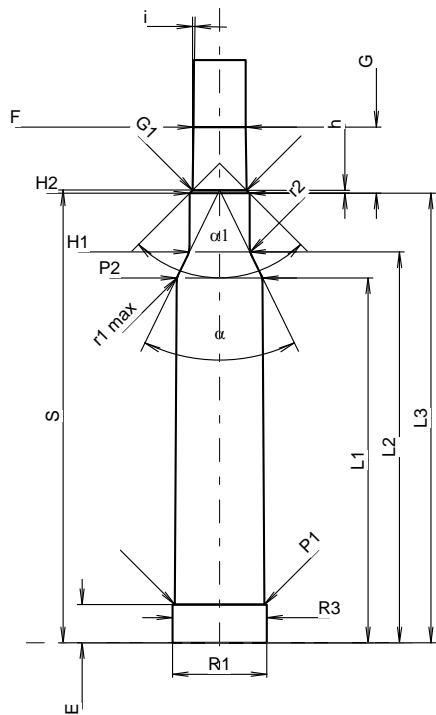

Échelle 1:1.1

Dimensions en << mm >>
Dimensions et tolérances pour les canons
d'épreuve: Voyez Annexe CR 1.

Notes: 1) A' contrôler pour la sécurité
* Dimensions de base