

C.I.P.**350 Rem. Mag.**

TAB.

III

Date

84-06-14

Révision

02-05-15

Pays d'origine: US

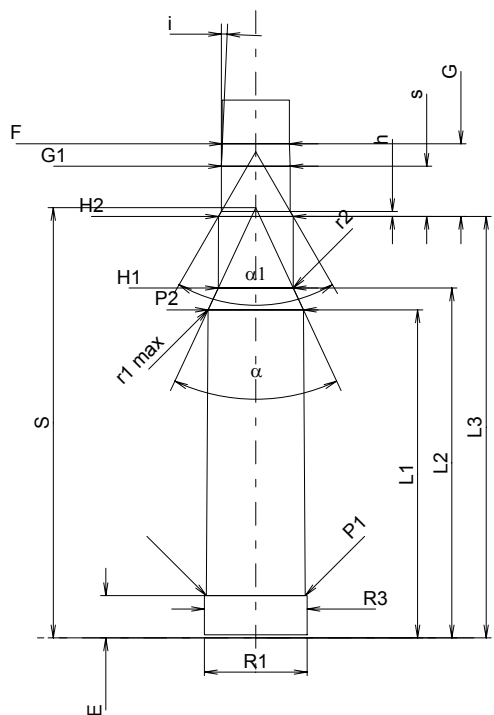
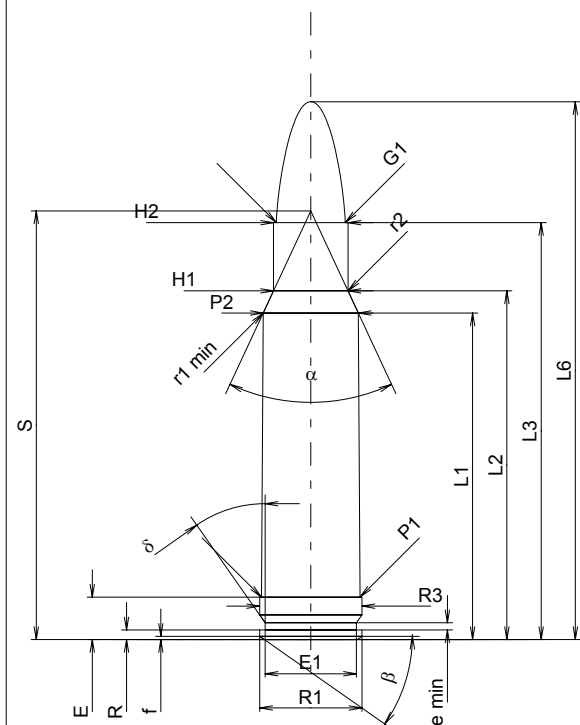

Échelle 1:1

Dimensions en << mm >>
Dimensions et tolérances pour les canons
d'épreuve: Voyez Annexe CR 1.

CARTOUCHE MAXI**Longueurs**

L1	=	43.18
L2	=	46.10
L3 ¹⁾	=	55.12
L4	=	
L5	=	
L6	=	71.12

Culot

R	=	1.27
R1	=	13.51
R3	=	13.51
E ¹⁾	=	5.59
E1	=	12.07
e min	=	0.94
delta	=	35°
f	=	0.41
beta	=	35°

Chambre à poudre

P1	=	13.03
P2*	=	12.58

Cône de raccordement

alpha*	=	50°
S*	=	56.67
r1 min	=	0.76
r2	=	2.54

Collet

H1*	=	9.86
H2 ¹⁾	=	9.86

Projectile

G1 ¹⁾	=	9.12
G2	=	
F	=	
L3+G ¹⁾	=	64.74

Pressions (Énergies)**Méthode transducteur**

Pmax	=	4300 bar
PK	=	4945 bar
PE	=	5375 bar
M	=	25.00
EE	=	4620 Joule

Autres indications

Fe ¹⁾	=	0.10
delta L	=	

CHAMBRE MINI**Longueurs**

L1	=	43.39
L2	=	46.27
L3 ¹⁾	=	55.73

Cuvette

R	=	
R1	=	13.59
R2	=	
R3	=	13.59
r	=	

Chambre à poudre

E ¹⁾	=	5.59
P1 ¹⁾	=	13.06
P2*	=	12.60

Cône de raccordement

alpha*	=	50°
S*	=	56.90
r1 max	=	0.76
r2	=	2.79

Collet

H1*	=	9.91
H2 ¹⁾	=	9.88

Prise de rayures

G1 ^{1)*}	=	9.12
G ¹⁾	=	9.62
alpha1*	=	60°
h	=	0.65
s	=	6.64
i ^{1)*}	=	2°30'
w	=	

Canon

F ^{1)*}	=	8.86
Z ¹⁾	=	9.07

Rayures

b	=	3.30
N	=	6
u	=	406.00
Q	=	63.78 mm ²

Notes: 1) A' contrôler pour la sécurité
* Dimensions de base