

C.I.P.**240 Belt. Riml. N.E.**

TAB.

III

Date

84-06-14

Révision

02-05-15

Pays d'origine: GB

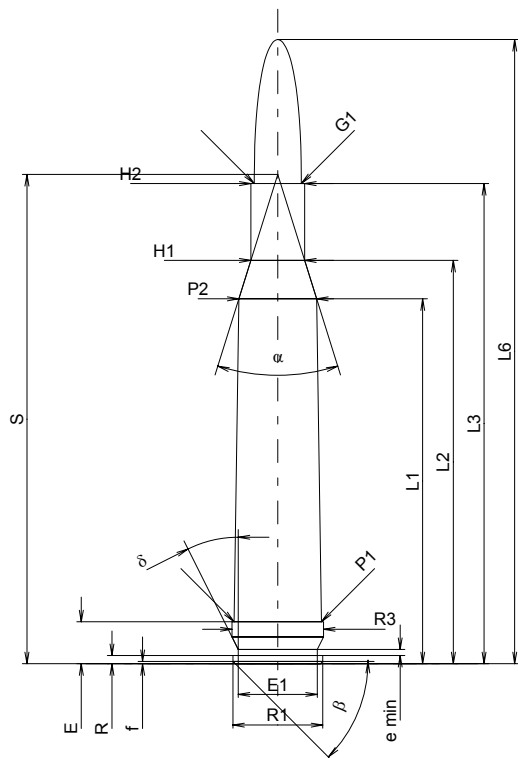
**CARTOUCHE MAXI****Longueurs**

L1*	=	48.26
L2*	=	53.34
L3 ¹⁾	=	63.50
L4	=	
L5	=	
L6	=	82.55

Culot

R	=	1.09
R1	=	11.89
R3	=	12.12
E ¹⁾	=	5.56
E1	=	10.46
e min	=	0.81
delta	=	26°34'12"
f	=	0.30
beta	=	45°

Chambre à poudre

P1	=	11.56
P2*	=	10.29

Cône de raccordement

alpha	=	34°45'33"
S	=	64.70
r1 min	=	
r2	=	

Collet

H1*	=	7.11
H2 ¹⁾	=	7.11

Projectile

G1 ¹⁾	=	6.22
G2	=	
F	=	
L3+G ¹⁾	=	68.71

Pressions (Énergies)**Méthode transducteur**

Pmax	=	3300 bar
PK	=	3795 bar
PE	=	4125 bar
M	=	25.00
EE	=	2625 Joule

Autres indications

Fe ¹⁾	=	0.15
delta L	=	

CHAMBRE MINI**Longueurs**

L1*	=	48.41
L2*	=	53.46
L3 ¹⁾	=	64.00

Cuvette

R	=	
R1	=	12.17
R2	=	
R3	=	12.17
r	=	

Chambre à poudre

E ¹⁾	=	5.56
P1 ¹⁾	=	11.56
P2*	=	10.32

Cône de raccordement

alpha	=	34°44'49"
S	=	64.90
r1 max	=	
r2	=	

Collet

H1*	=	7.16
H2 ¹⁾	=	7.14

Prise de rayures

G1 ^{1)*}	=	6.27
G ^{1)*}	=	5.21
alpha1	=	90°
h*	=	0.44
s	=	
i ¹⁾	=	1°30'04"
w	=	

Canon

F ^{1)*}	=	6.02
Z ¹⁾	=	6.22

Rayures

b	=	3.50
N	=	4
u	=	203.00
Q	=	29.95 mm ²

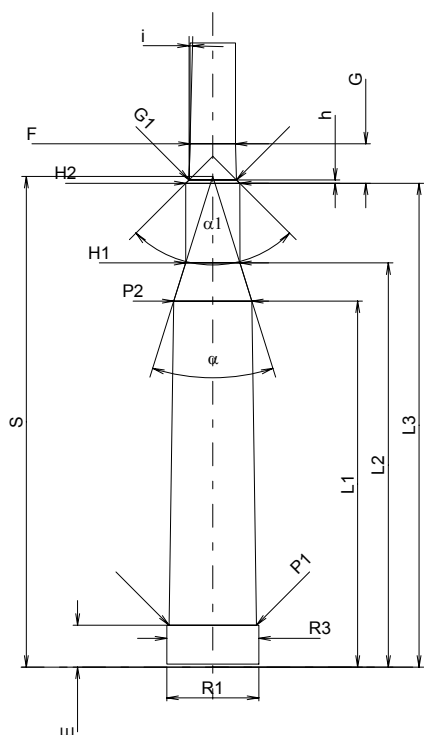

Échelle 1:1

Dimensions en << mm >>
Dimensions et tolérances pour les canons
d'épreuve: Voyez Annexe CR 1.

Notes: 1) A' contrôler pour la sécurité
* Dimensions de base