

# C.I.P.

## 500 S&W Mag

Country of Origin: US

TAB. IV

Date 04-05-18

Revision 14-05-20

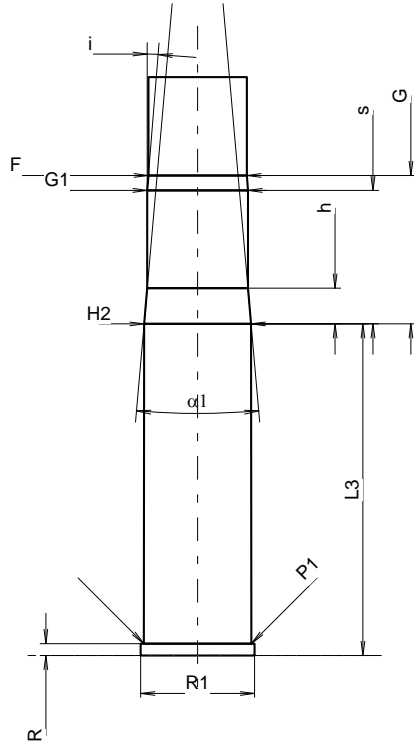
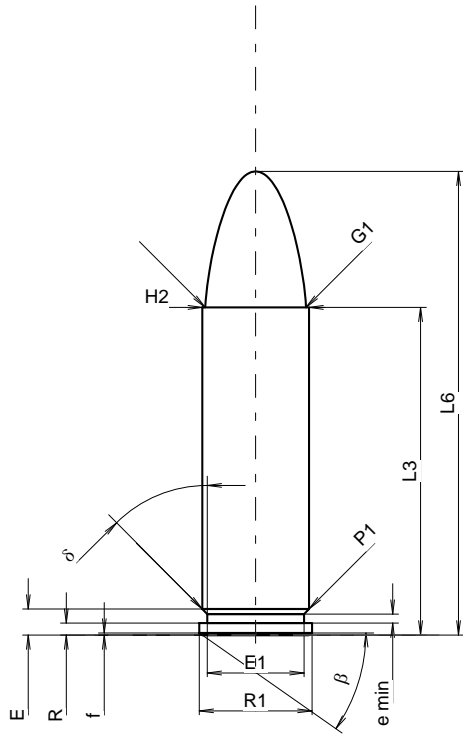

Scale 1.05:1

Dimensions in << mm >>  
Dimensions and Tolerances for Proof Barrels  
see Appendix CR 1.

### CARTRIDGE MAXI

#### Lengths

L1	=	
L2	=	
L3 <sup>1)</sup>	=	41.28
L4	=	
L5	=	
L6	=	58.42

#### Case Head

R <sup>1)</sup>	=	1.50	-0.25
R1	=	14.22	
R3	=		
E	=	3.28	
E1	=	12.19	
e min	=	1.14	
delta	=	45°	
f	=	0.26	
beta	=	35°	

#### Powder Chamber

P1	=	13.46
P2	=	

#### Junction Cone

alpha	=	
S	=	
r1 min	=	
r2	=	

#### Collar

H1	=	
H2 <sup>1)</sup>	=	13.46

#### Projectile

G1 <sup>1)</sup>	=	12.70
G2	=	
F	=	
L3+G <sup>1)</sup>	=	59.98

#### Pressures (Energies)

#### Method Transducer

Pmax	=	3700 bar
PK	=	4255 bar
PE	=	4810 bar
M	=	23.00

#### Miscellaneous Dimensions

Fe <sup>1)4)</sup>	=	0.25
delta L	=	

### CHAMBER MINI

#### Lengths

L1	=	
L2	=	
L3 <sup>1)</sup>	=	41.79

#### Breech

R <sup>1)</sup>	=	1.50
R1	=	14.35
R2	=	
R3	=	
r	=	

#### Powder Chamber

E	=	
P1 <sup>1)</sup>	=	13.54
P2	=	

#### Junction Cone

alpha	=	
S	=	
r1 max	=	
r2	=	

#### Collar

H1	=	
H2 <sup>1)</sup>	=	13.49

#### Commencement of Rifling

G1 <sup>1)</sup> *	=	12.70
G <sup>1)</sup>	=	18.70
alpha1 *	=	10°
h	=	4.51
s *	=	16.83
i <sup>1)</sup> *	=	4°35'
w	=	

#### Barrel

F <sup>1)</sup> *	=	12.40
Z <sup>1)</sup>	=	12.66

#### Grooves

b	=	3.30
N	=	6
u	=	476.30
Q	=	123.37 mm <sup>2</sup>

Notes: 1) Check for safety reasons  
4) Headspace on Rim  
\* Basic dimensions