

C.I.P.**30 PICRA**

Ursprungsland: CZ

TAB. IV

Datum 99-04-20

Revision 00-06-07

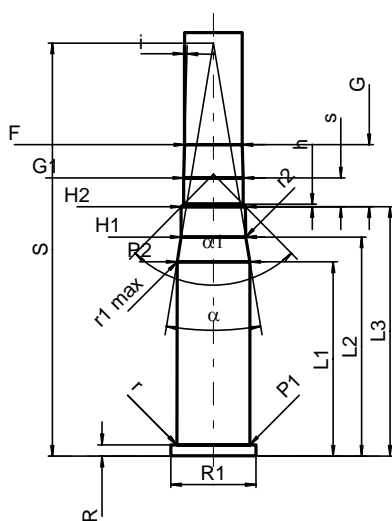
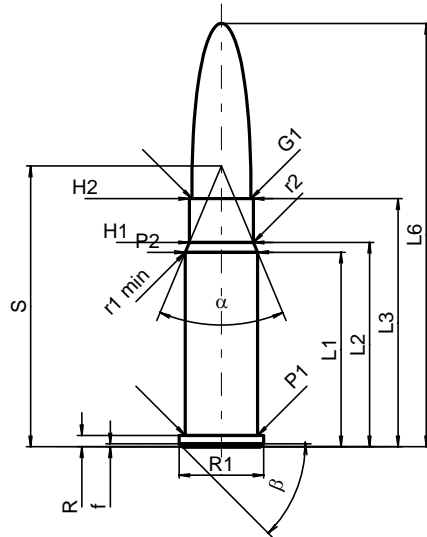

Maßstab 1:1

Maße in << mm >>
Maße und Toleranzen für Messläufe
siehe Anhang CR 1.

PATRONE MAXI**Längen**

L1 ^{1)*}	=	25.72	-0.20
L2 ^{1)*}	=	27.03	-0.20
L3 ¹⁾	=	32.80	
L4	=		
L5	=		
L6	=	56.00	

Hülsenboden

R	=	1.50	
R1	=	11.18	
R3	=		
E	=		
E1	=		
e min	=		
delta	=		
f	=	0.38	
beta	=	45°	

Pulverkammer

P1	=	9.60	
P2 ^{1)*}	=	9.57	-0.20

Schulterkonus

alpha	=	45°33'	
S	=	37.12	
r1 min	=	0.76	
r2	=	2.54	

Hülsenhals

H1*	=	8.47	
H2 ¹⁾	=	8.47	

Geschoss

G1 ¹⁾	=	7.82	
G2	=		
F	=		
L3+G ¹⁾	=	40.99	

Drücke (Energien)**Mech. elektr. Wandler**

Pmax	=	2800 bar	
PK	=	3220 bar	
PE	=	3640 bar	
M	=	17.50	

Verschiedene Daten

Fe ¹⁾	=	0.15	
delta L	=		

PATRONELAGER MINI**Längen**

L1*	=	25.70	
L2*	=	28.98	
L3 ¹⁾	=	33.00	

Stoßboden

R	=	1.52	
R1	=	11.28	
R2	=		
R3	=		
r	=	0.20	

Pulverkammer

E	=		
P1 ¹⁾	=	9.63	
P2*	=	9.61	

Schulterkonus

alpha ¹⁾	=	18°52'05"	
S	=	54.62	
r1 max	=	0.50	
r2	=	0.50	

Hülsenhals

H1*	=	8.52	
H2 ¹⁾	=	8.50	

Geschossübergang

G1 ^{1)*}	=	7.85	
G ^{1)*}	=	8.19	
alpha 1	=	89°07'31"	
h	=	0.33	
s*	=	3.80	
i ¹⁾	=	1°30'02"	
w	=		

Lauf

F ^{1)*}	=	7.62	
Z ¹⁾	=	7.82	

Züge

b	=	4.49	
N	=	4	
u	=	254.00	
Q	=	47.52	mm ²

Bemerkungen: 1) Kontrolle aus Sicherheitsgründen
* Grundmaße