

C.I.P.**357 Auto Mag.**

TAB. IV

Datum 84-06-14

Revision 08-09-23

Ursprungsland: US

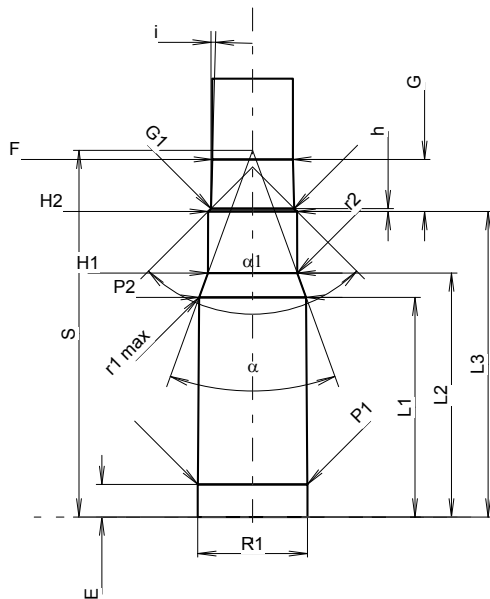
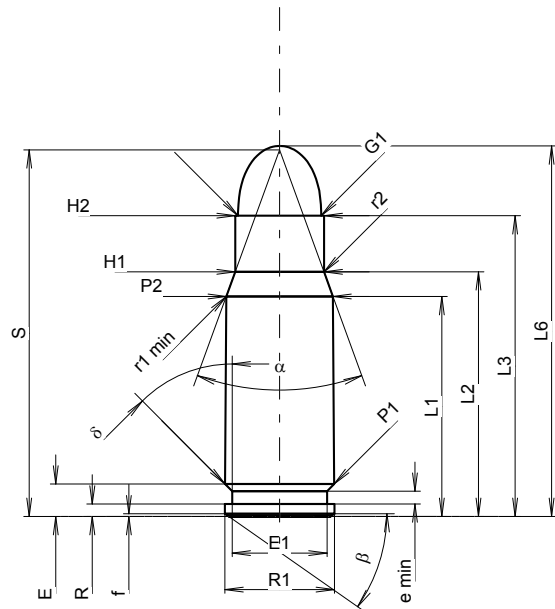

Maßstab 1.21:1

Maße in << mm >>
Maße und Toleranzen für Messläufe
siehe Anhang CR 1.

PATRONE MAXI**Längen**

L1 ¹⁾	=	24.13	-0.20
L2 ¹⁾	=	26.83	-0.20
L3 ¹⁾	=	33.00	
L4	=		
L5	=		
L6	=	40.65	

Hülsenboden

R	=	1.37	
R1	=	12.01	
R3	=		
E	=	3.56	
E1	=	10.40	
e min	=	1.40	
delta	=	45°	
f	=	0.30	
beta	=	35°	

Pulverkammer

P1	=	11.97	
P2 ¹⁾ *	=	11.71	-0.20

Schulterkonus

alpha *	=	40°	
S *	=	40.22	
r1 min	=	1.00	
r2	=	3.20	

Hülsenhals

H1 *	=	9.75	
H2 ¹⁾	=	9.75	

Geschoss

G1 ¹⁾	=	9.12	
G2	=		
F	=		
L3+G ¹⁾	=	38.73	

Drücke (Energien)**Mech. elektr. Wandler**

Pmax	=	2550 bar	
PK	=	2933 bar	
PE	=	3315 bar	
M	=	17.50	

Verschiedene Daten

Fe ¹⁾³⁾	=	0.15	
delta L	=		

PATRONENLAGER MINI**Längen**

L1	=	24.09	
L2	=	26.76	
L3 ¹⁾	=	33.50	

Stoßboden

R	=	1.37	
R1	=	12.04	
R2	=		
R3	=		
r	=		

Pulverkammer

E	=	3.56	
P1 ¹⁾	=	11.99	
P2 *	=	11.74	

Schulterkonus

alpha ¹⁾ *	=	40°	
S *	=	40.22	
r1 max	=	1.00	
r2	=	3.20	

Hülsenhals

H1 *	=	9.80	
H2 ¹⁾	=	9.78	

Geschossübergang

G1 ¹⁾ *	=	9.13	
G ¹⁾	=	5.73	
alpha1 *	=	90°	
h	=	0.32	
s	=		
i ¹⁾ *	=	1°32'17"	
w	=		

Lauf

F ¹⁾ *	=	8.84	
Z ¹⁾	=	9.09	

Züge

b	=	2.69	
N	=	6	
u	=	457.00	
Q	=	63.42	mm ²

Bemerkungen: 1) Kontrolle aus Sicherheitsgründen
3) Verschlussabstand an Schulter
* Grundmaße