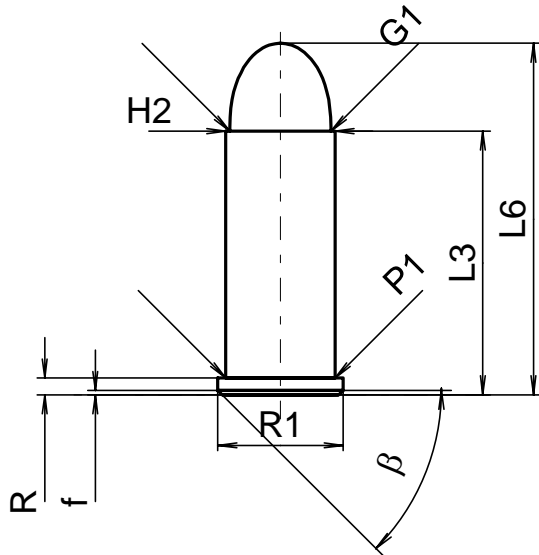

C.I.P.**38/357 FX**

Ursprungsland: CA

TAB.	IV
Datum	98-01-27
Revision	00-06-07

**PATRONE MAXI****Längen**

L1	=	
L2	=	
L3 ¹⁾	=	23.24
L4	=	
L5	=	
L6	=	30.99

Hülsenboden

R ¹⁾	=	1.47	-0.25
R1	=	11.05	
R3	=		
E	=		
E1	=		
e min	=		
delta	=		
f	=	0.38	
beta	=	45°	

Pulverkammer

P1	=	9.63
P2	=	

Schulterkonus

alpha	=	
S	=	
r1 min	=	
r2	=	

Hülsenhals

H1	=	
H2 ¹⁾	=	9.63

Geschoss

G1 ¹⁾	=	8.94
G2	=	
F	=	
L3+G	=	

Drücke (Energien)**Mech. elektr. Wandler**

Pmax	=	350 bar
PK	=	403 bar
PE	=	455 bar
M	=	12.50

Verschiedene Daten

Fe ¹⁾	=	0.25
delta L	=	

PATRONENLAGER MINI**Längen**

L1	=	
L2	=	
L3 ¹⁾	=	23.38

Stoßboden

R ¹⁾	=	1.47
R1	=	13.38
R2	=	
R3	=	
r	=	

Pulverkammer

E	=	
P1 ¹⁾	=	9.68
P2	=	

Schulterkonus

alpha	=	
S	=	
r1 max	=	
r2	=	

Hülsenhals

H1	=	
H2 ¹⁾	=	9.68

Geschossübergang

G1 ^{1)*}	=	8.79
G	=	
alpha1	=	
h	=	
s	=	
i	=	
w	=	

Lauf

F ^{1)*}	=	8.79
Z ¹⁾	=	9.02

Züge

b	=	2.48
N	=	6
u	=	254.00
Q	=	62.42 mm ²

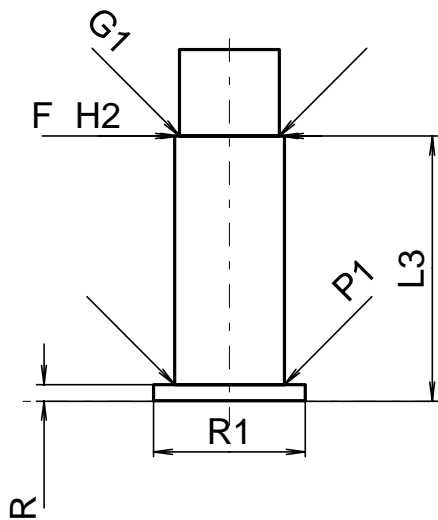

Maßstab 1.5:1

Maße in << mm >>
Maße und Toleranzen für Messläufe
siehe Anhang CR 1.

Bemerkungen: 1) Kontrolle aus Sicherheitsgründen
* Grundmaße