

C.I.P.**45 S&W Schofield**

TAB. IV

Date 00-02-15

Revision 00-06-07

Country of Origin: US

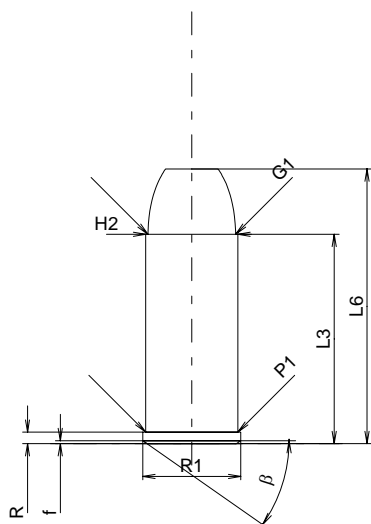
**Maximum Cartridge****Cartridge Lengths**

L1	=	
L2	=	
L3 ¹⁾	=	27.69
L4	=	
L5	=	
L6	=	36.32

Cartridge Head

R ¹⁾	=	1.52	-0.25
R1	=	12.95	
R3	=		
E	=		
E1	=		
e min	=		
delta	=		
f	=	0.40	
beta	=	35°	

Cartridge Body

P1	=	12.19
P2	=	

Cartridge Shoulder

alpha	=	
S	=	
r1 min	=	
r2	=	

Cartridge Neck

H1	=	
H2 ¹⁾	=	12.19

Bullet

G1 ¹⁾	=	11.58
G2	=	
F	=	
L3+G1 ¹⁾	=	38.97

Pressures (Energies)**Method Transducer**

Pmax	=	1000 bar
PK	=	1150 bar
PE	=	1300 bar
M	=	12.50

Miscellaneous Dimensions

Fe ¹⁾	=	0.25
delta L	=	

Minimum Chamber**Chamber Lengths**

L1	=	
L2	=	
L3 ¹⁾	=	27.94

Chamber Head

R ¹⁾	=	1.52
R1	=	13.01
R2	=	
R3	=	
r	=	

Powder Chamber

E	=	
P1 ¹⁾	=	12.37
P2	=	

Chamber Shoulder

alpha	=	
S	=	
r1 max	=	
r2	=	

Chamber Neck

H1	=	
H2 ¹⁾	=	12.19

Throat Dimensions

G1 ^{1)*}	=	11.50
G ¹⁾	=	11.28
alpha1 [*]	=	15°30'
h	=	2.54
s	=	9.60
i ^{1)*}	=	4°34'59"
w	=	

Barrel Dimensions

F ^{1)*}	=	11.23
Z ¹⁾	=	11.43

Rifling

b	=	3.96
N	=	6
u	=	406.00
Q	=	101.48 mm ²

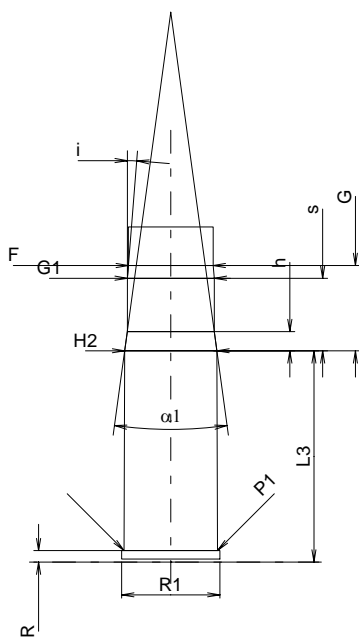

Scale 1:1

Dimensions in << mm >>
Dimensions and Tolerances for Proof Barrels
see Appendix CR 1.

Notes: 1) Check for safety reasons
* Basic dimensions