

C.I.P.**45 S&W Schofield (carb)**

TAB. IV

Date 00-02-15

Country of Origin: US

Revision

CARTRIDGE MAXI**CHAMBER MINI****Lengths**

L1 =
 L2 =
 L3 =
 L4 =
 L5 =
 L6 =

Lengths

L1 =
 L2 =
 L3 ¹⁾ = 27.94

Case Head

R =
 R1 =
 R3 =
 E =
 E1 =
 e min =
 δ =
 f =
 β =

Breech

R ¹⁾ = 1.52
 R1 = 13.01
 R2 =
 R3 =
 r =

Powder Chamber

P1 =
 P2 =

Powder Chamber

E =
 P1 ¹⁾ = 12.37
 P2 =

Junction Cone

α =
 S =
 r1 min =
 r2 =

Junction Cone

α =
 S =
 r1 max =
 r2 =

Collar

H1 =
 H2 =

Collar

H1 =
 H2 ¹⁾ = 12.19

Projectile

G1 =
 G2 =
 F =
 L3+G =

Commencement of Rifling

G1 ^{1)*} = 12.19
 G ¹⁾ = 3.53
 α1 ^{*} =
 h =
 s =
 j ^{1)*} = 7°45'
 w =

Pressures (Energies)**Barrel**

F ^{1)*} = 11.23
 Z ¹⁾ = 11.43

Grooves

b = 3.96
 N = 6
 u = 406.00
 Q = 101.48 mm²

Miscellaneous Dimensions

Fe ¹⁾ = 0.15
 delta L =

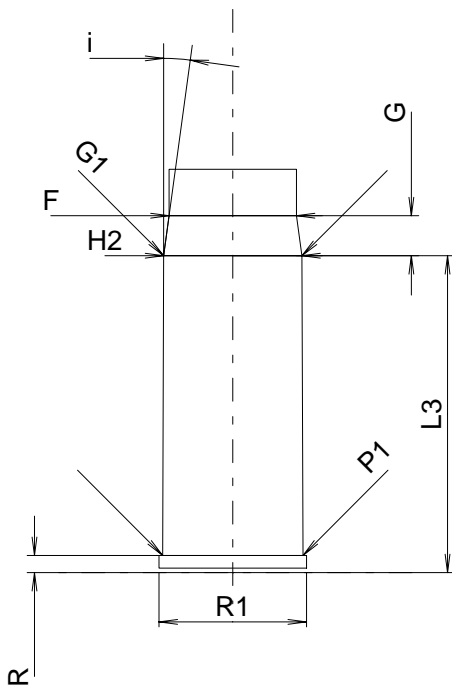

Scale 1.5:1

Dimensions in << mm >>

Notes: 1) Check for safety reasons
 * Basic dimensions