

**C.I.P.****22 Extra L.R.**

Country of Origin: US

TAB. V

Date 89-09-08

Revision 00-06-07

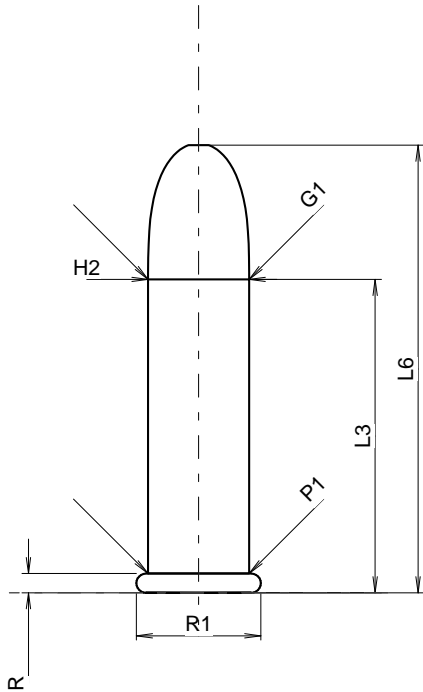
**CARTRIDGE MAXI****Lengths**

L1	=	
L2	=	
L3 <sup>1)</sup>	=	17.78
L4	=	
L5	=	
L6	=	25.40

**Case Head**

R <sup>1)</sup>	=	1.09	-0.18
R1	=	7.06	
R3	=		
E	=		
E1	=		
e min	=		
δ	=		
f	=		
β	=		

**Powder Chamber**

P1	=	5.74
P2	=	

**Junction Cone**

α	=	
S	=	
r1 min	=	
r2	=	

**Collar**

H1	=	
H2 <sup>1)</sup>	=	5.74

**Projectile**

G1 <sup>1)</sup>	=	5.73
G2	=	
F	=	
L3+G <sup>1)</sup>	=	19.27

**Pressures (Energies)****Method Crusher**

Pmax	=	1800 bar
PK	=	2070 bar
PE	=	2340 bar
M	=	19.58

**Miscellaneous Dimensions**

Fe <sup>1)</sup>	=	0.20
delta L	=	

**CHAMBER MINI****Lengths**

L1	=	
L2	=	
L3 <sup>1)</sup>	=	20.78

**Breech**

R <sup>1)</sup>	=	1.09
R1	=	7.32
R2	=	
R3	=	
r	=	0.13

**Powder Chamber**

E	=	
P1 <sup>1)</sup>	=	5.86
P2	=	

**Junction Cone**

α	=	
S	=	
r1 max	=	
r2	=	

**Collar**

H1	=	
H2 <sup>1)</sup>	=	5.77

**Commencement of Rifling**

G1 *	=	5.77
G	=	1.49
α1	=	
h	=	
s	=	
i *	=	5°
w	=	

**Barrel**

F <sup>1)</sup> *	=	5.51
Z <sup>1)</sup>	=	5.64

**Grooves**

b	=	2.16
N	=	6
u	=	406.00
Q	=	24.71 mm <sup>2</sup>

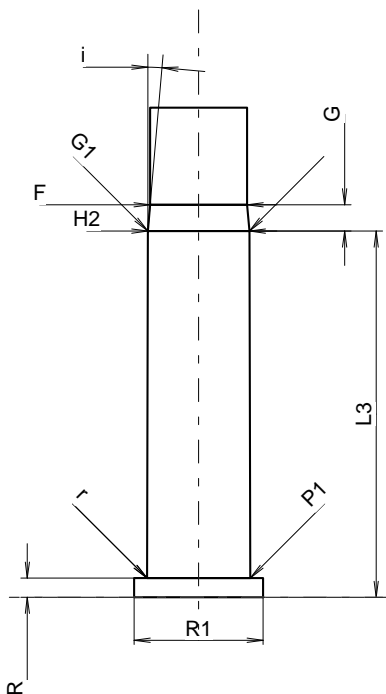

Scale 2.33:1

Dimensions in << mm >>  
 Dimensions and Tolerances for Proof Barrels  
 see Appendix CR 2.

Notes: 1) Check for safety reasons  
 \* Basic dimensions