

C.I.P.

22 Win. Mag. R.F.

Country of Origin: US

TAB. V

Date 84-06-14

Revision 08-09-23

Alternative Names: 22 Win.Mag.,22 WMR, 22 Magnum

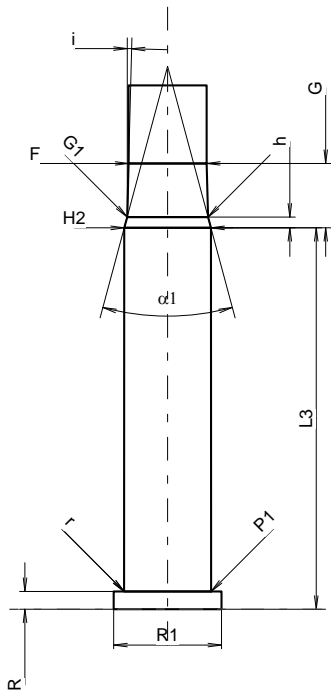
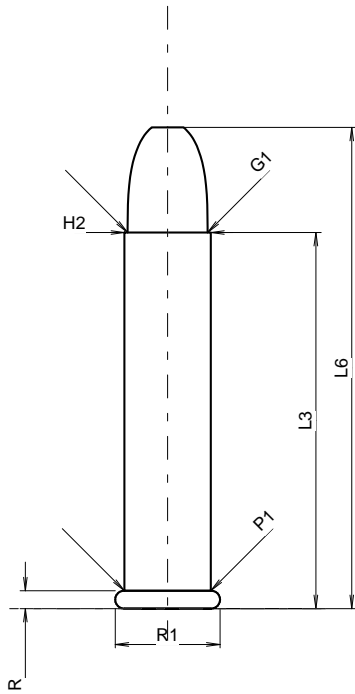

Scale 1.86:1

Dimensions in << mm >>
Dimensions and Tolerances for Proof Barrels
see Appendix CR 2.**CARTRIDGE MAXI****Lengths**

L1	=	
L2	=	
L3 ¹⁾	=	26.80
L4	=	
L5	=	
L6	=	34.29

Case Head

R ¹⁾	=	1.27	-0.18
R1	=	7.47	
R3	=		
E	=		
E1	=		
e min	=		
δ	=		
f	=		
β	=		

Powder Chamber

P1	=	6.15
P2	=	

Junction Cone

α	=	
S	=	
r1 min	=	
r2	=	

Collar

H1	=	
H2 ¹⁾	=	6.15

Projectile

G1 ¹⁾	=	5.70
G2	=	
F	=	
L3+G ¹⁾	=	31.39

Pressures (Energies)**Method Transducer**

Pmax	=	1600 bar
PK	=	1840 bar
PE	=	2080 bar
M	=	17.50

Miscellaneous Dimensions

Fe ¹⁾⁴⁾	=	0.20
delta L	=	

CHAMBER MINI**Lengths**

L1	=	
L2	=	
L3 ¹⁾	=	27.18

Breech

R ¹⁾	=	1.27
R1	=	7.67
R2	=	
R3	=	
r	=	0.25

Powder Chamber

E	=	
P1 ¹⁾	=	6.20
P2	=	

Junction Cone

α	=	
S	=	
r1 max	=	
r2	=	

Collar

H1	=	
H2 ¹⁾	=	6.17

Commencement of Rifling

G1 *	=	5.76
G	=	4.59
α1 *	=	30°
h	=	0.77
s	=	
i *	=	1°30'
w	=	

Barrel

F ¹⁾ *	=	5.56
Z ¹⁾	=	5.69

Grooves

b	=	1.88
N	=	6
u	=	406.00
Q	=	25.03 mm ²

Notes: 1) Check for safety reasons
4) Headspace on Rim
* Basic dimensions