

C.I.P.

5 mm Rem. Mag.

Country of Origin: US

TAB. V

Date 84-06-14

Revision 00-06-07

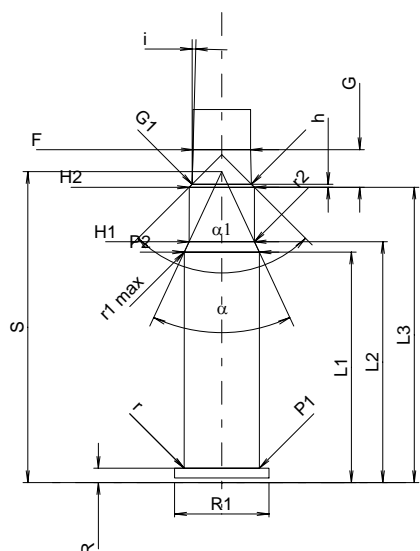
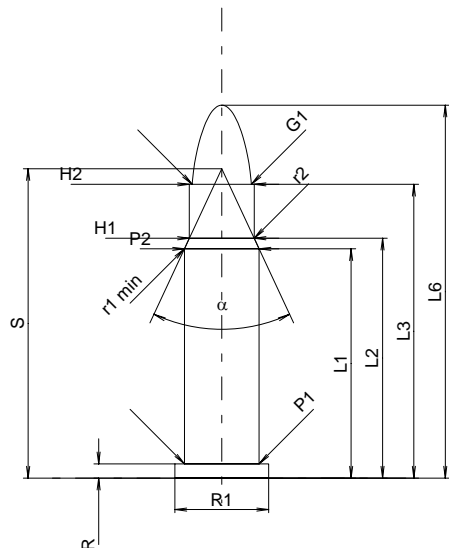

Scale 1.5:1

Dimensions in << mm >>
Dimensions and Tolerances for Proof Barrels
see Appendix CR 2.

CARTRIDGE MAXI

Lengths

L1	=	20.22
L2	=	21.15
L3 ¹⁾	=	25.91
L4	=	
L5	=	
L6	=	32.89

Case Head

R ¹⁾	=	1.26	-0.18
R1	=	8.26	
R3	=		
E	=		
E1	=		
e min	=		
delta	=		
f	=		
beta	=		

Powder Chamber

P1	=	6.58
P2*	=	6.58

Junction Cone

alpha*	=	50°
S*	=	27.28
r1 min	=	1.14
r2	=	1.78

Collar

H1*	=	5.72
H2 ¹⁾	=	5.72

Projectile

G1 ¹⁾	=	5.21
G2	=	
F	=	
L3+G ¹⁾	=	29.23

Pressures (Energies)

Method Crusher

Pmax	=	2550 bar
PK	=	2933 bar
PE	=	3315 bar
M	=	27.71

Miscellaneous Dimensions

Fe ¹⁾	=	0.10
delta L	=	

CHAMBER MINI

Lengths

L1 ¹⁾	=	20.32
L2	=	21.24
L3 ¹⁾	=	26.04

Breech

R ¹⁾	=	1.26
R1	=	8.31
R2	=	
R3	=	
r	=	0.30

Powder Chamber

E	=	
P1 ¹⁾	=	6.63
P2*	=	6.61

Junction Cone

alpha*	=	50°
S*	=	27.41
r1 max	=	1.14
r2	=	1.91

Collar

H1*	=	5.75
H2 ¹⁾	=	5.74

Commencement of Rifling

G1*	=	5.23
G	=	3.32
alpha1*	=	90°
h	=	0.26
s	=	
i*	=	1°30'
w	=	

Barrel

F ¹⁾ *	=	5.07
Z ¹⁾	=	5.19

Grooves

b	=	2.08
N	=	6
u	=	305.00
Q	=	20.96 mm ²

Notes: 1) Check for safety reasons
* Basic dimensions