

C.I.P.	Cal. 12	TAB.	VII
		Date	84-06-14
		Revision	18-10-17

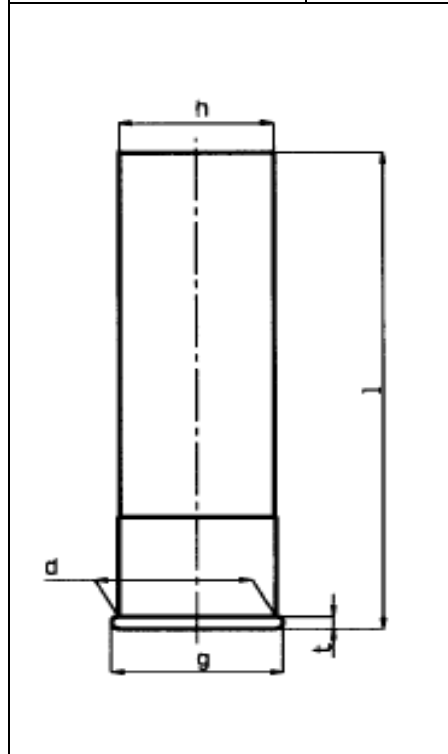

CARTIDGE MAXIMALE

Dimens. Vale Toler.

d ¹⁾	= 20.60	- 0.28	
g	= 22.45	- 0.48	
t ¹⁾	= 1.85	- 0.30	Marking
h	= 20.20	- 0.47	
l	= 35.00	- 2.50	12/35 T
l	= 55.00	- 2.50	12/55
l	= 60.00	- 2.50	12/60
l	= 65.00	- 2.50	12/65
l	= 67.50	- 2.50	12/67
l	= 69.80	- 2.50	12/70
l	= 72.80	- 2.50	12/73
l	= 76.00	- 2.50	12/76
l	= 88.70	- 2.50	12/89

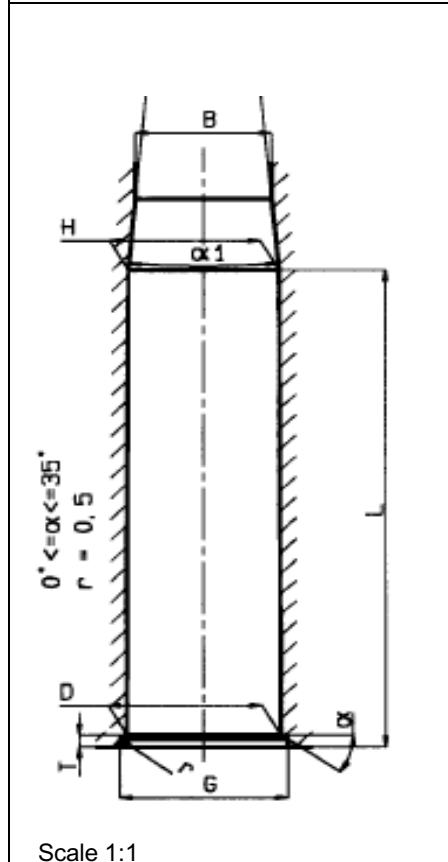

CHAMBER MINIMALE

Dimens. Value Toler.

D ¹⁾	= 20.65	+ 0.10					
G	= 22.55	+ 0.10					
T ¹⁾	= 1.85	+ 0.10					
H ¹⁾	= 20.30	+ 0.10	Marking	Pressure transducer			
B ¹⁾	= 18.20	+ 0.70		Pmax	PK	PE	M
α ¹⁾	= 10°30'	max		bar			
L ¹⁾	= 35.00	+ 2.00	12/35 T	150	173	188	25
L ¹⁾	= 55.10	+ 2.00	12/55	740	850	930	25/30
L ¹⁾	= 60.10	+ 2.00	12/60	740	850	930	25/30
L ¹⁾	= 65.10	+ 2.00	12/65	740	850	930	25/30
L ¹⁾	= 67.60	+ 2.00	12/67	740	850	930	25/30
L ¹⁾	= 69.90	+ 2.00	12/70	740	850	930	25/30
L ¹⁾	= 73.00	+ 2.00	12/73	1050	1200	1320	25/30
L ¹⁾	= 76.20	+ 2.00	12/76	1050	1200	1320	25/30
L ¹⁾	= 88.90	+ 2.00	12/89	1050	1200	1320	25/30

Headspace

Fe	= 0.10	Proof Barrel with bascule automatic
Fe ¹⁾	= 0.20	
Fe ²⁾	= 0.35	

Scale 1:1

Dimensions in « mm »
Dimensions and tolerances for Proof Barrels :
See Appendix CR 4.

Notes : 1) Check for safety reasons