

C.I.P.**5,56 mm MT-X**

TAB.

X

Datum

24-05-14

Ursprungsland: SI

Revision

PATRONE MAXI**PATRONENLAGER MINI****Längen**

L1	=	37.85	-0.25
L2	=	40.74	-0.30
L3 ¹⁾	=	46.45	-0.30
L4	=	42.50	
L5	=		
L6	=	54.10	

Längen

L1	=	37.91
L2	=	40.90
L3 ¹⁾	=	46.50

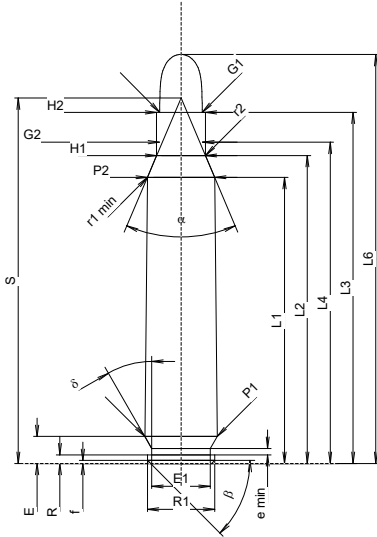
**Hülsenboden**

R	=	1.15
R1	=	8.88
R3	=	
E	=	3.58
E1	=	7.73
e min	=	0.85
delta	=	30°
f	=	0.40
beta	=	45°

Stoßboden

R	=	
R1	=	9.07
R2	=	
R3	=	
r	=	

Pulverkammer

P1	=	9.55
P2 ¹⁾ *	=	8.90 -0.20

Pulverkammer

E	=	4.62
P1 ¹⁾	=	9.61
P2 *	=	9.02

Schulterkonus

alpha *	=	46°
S *	=	48.33
r1 min	=	3.00
r2	=	2.52

Schulterkonus

alpha ¹⁾ *	=	46°
S *	=	48.53
r1 max	=	0.64
r2	=	3.18

Hülsenhals

H1 *	=	6.45
H2 ¹⁾	=	6.45

Hülsenhals

H1 *	=	6.48
H2 ¹⁾	=	6.45

Geschoss

G1 ¹⁾	=	5.60
G2	=	5.70
F	=	
L3+G ¹⁾	=	48.63

Geschossübergang

G1 ¹⁾ *	=	5.69
G ¹⁾	=	2.18
alpha 1	=	90°
h	=	0.38
s *	=	1.01
i ¹⁾ *	=	3°10'36"
w	=	

Drücke (Energien)**Energie**

E _{max}	=	8.5 Joule
E _K	=	9.1 Joule
E _E	=	9.4 Joule

Lauf

F ¹⁾ *	=	5.56
Z ¹⁾	=	5.69

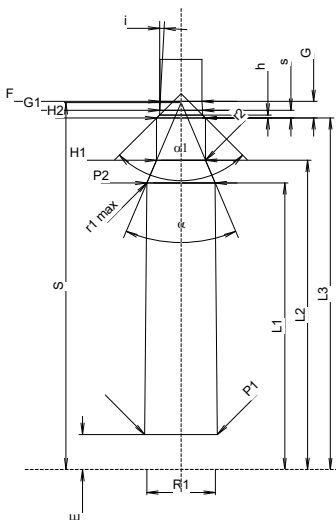
**Verschiedene Daten**

Fe ³⁾	=	0.15
delta L	=	

Züge

b	=	1.88
N	=	6
u	=	305.00
Q	=	25.03 mm ²

Maßstab 1:1

Maße in << mm >>
Maße und Toleranzen für Messläufe
siehe Anhang CR1.

Bemerkungen: 1) Kontrolle aus Sicherheitsgründen
3) Verschlussabstand an Schulter
* Grundmaße