

**C.I.P.****57TK**

TAB. X

Datum 17-05-17

Ursprungsland: RU

Revision

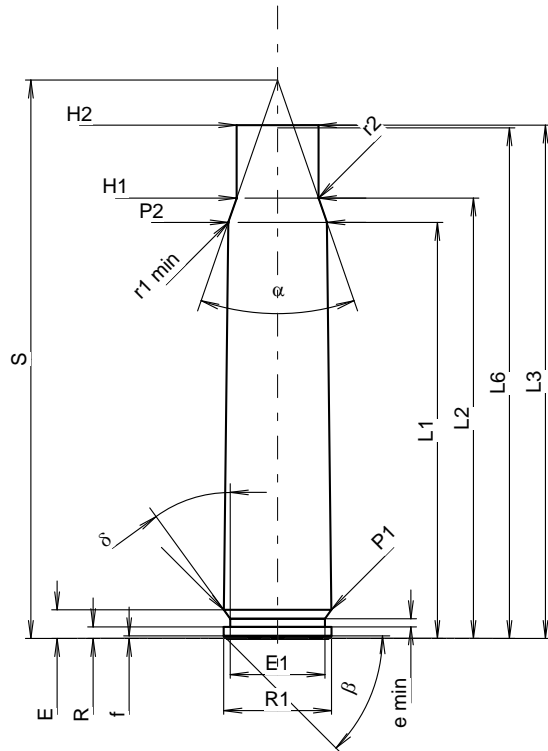
**PATRONE MAXI****Längen**

L1	=	46.20	-0.20
L2	=	48.90	-0.20
L3 <sup>1)</sup>	=	57.00	
L4	=		
L5	=		
L6	=	56.70	

**Hülsenboden**

R	=	1.30	
R1	=	11.95	
R3	=		
E	=	3.19	
E1	=	10.50	
e min	=	0.90	
delta	=	36°	
f	=	0.30	
beta	=	45°	

**Pulverkammer**

P1	=	11.94	
P2 *	=	10.95	-0.20

**Schulterkonus**

alpha *	=	38°12'6"	
S	=	62.01	
r1 min	=	0.50	
r2	=	0.50	

**Hülsenhals**

H1 *	=	9.08	
H2 <sup>1)</sup>	=	9.08	

**Geschoss**

G1	=		
G2	=		
F	=		
L3+G <sup>1)</sup>	=	57.00	

**Drücke (Energien)****Mech. elektr. Wandler**

Pmax	=	1800 bar	
PK	=	2070 bar	
PE	=	2340 bar	
M	=	25.00	

**Verschiedene Daten**

Fe <sup>1)3)</sup>	=	0.15	
delta L	=	0.02	

**PATRONENLAGER MINI****Längen**

L1	=	46.15	
L2	=	48.84	
L3	=	57.30	

**Stoßboden**

R	=	1.30	
R1	=	12.00	
R2	=		
R3	=		
r	=		

**Pulverkammer**

E	=	3.19	
P1	=	11.97	
P2 *	=	10.98	

**Schulterkonus**

alpha	=	38°19'59"	
S *	=	61.95	
r1 max	=	0.50	
r2	=	0.50	

**Hülsenhals**

H1 *	=	9.11	
H2 <sup>1)</sup>	=	9.10	

**Geschossübergang**

G1 <sup>1)</sup> *	=	5.00	
G	=		
alpha 1	=	60°	
h *	=	3.55	
s	=		
i	=		
w	=		

**Lauf**

F <sup>1)</sup> *	=	5.00	
Z	=		

**Züge**

b	=		
N	=		
u	=		
Q	=	19.63	mm <sup>2</sup>

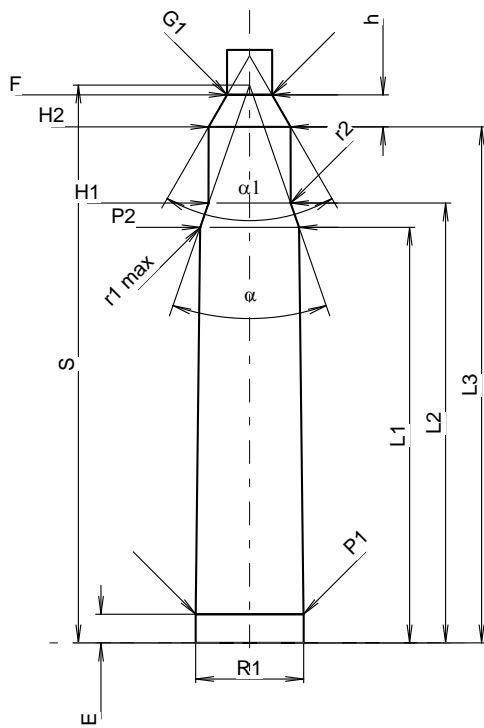

Maßstab 1.19:1

Maße in << mm >>  
Maße und Toleranzen für Messläufe  
siehe Anhang CR 5.

Bemerkungen: 1) Kontrolle aus Sicherheitsgründen  
2) Toleranz für Messlauf  
3) Verschussabstand an Schulter  
\* Grundmaße