

C.I.P.**57TK**

TAB.

X

Date

17-05-17

Revision

Country of Origin: RU

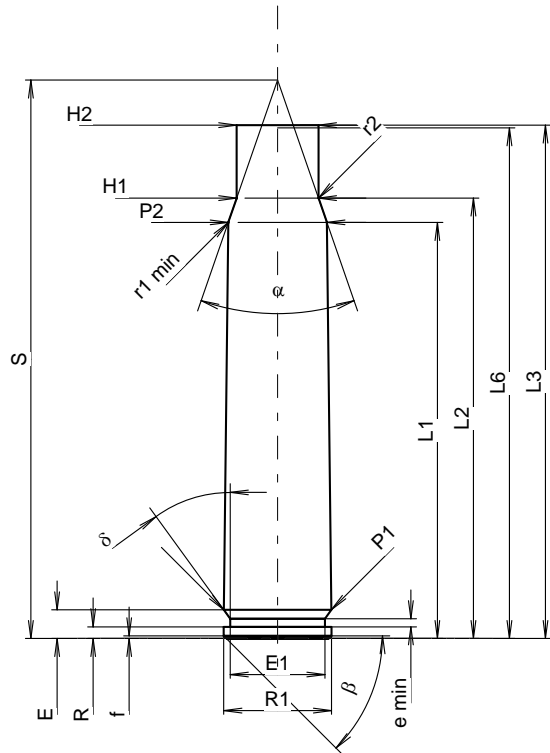
**CARTRIDGE MAXI****Lengths**

L1	=	46.20	-0.20
L2	=	48.90	-0.20
L3 ¹⁾	=	57.00	
L4	=		
L5	=		
L6	=	56.70	

Case Head

R	=	1.30	
R1	=	11.95	
R3	=		
E	=	3.19	
E1	=	10.50	
e min	=	0.90	
delta	=	36°	
f	=	0.30	
beta	=	45°	

Powder Chamber

P1	=	11.94	
P2 *	=	10.95	-0.20

Junction Cone

alpha *	=	38°12'6"	
S	=	62.01	
r1 min	=	0.50	
r2	=	0.50	

Collar

H1 *	=	9.08	
H2 ¹⁾	=	9.08	

Projectile

G1	=		
G2	=		
F	=		
L3+G ¹⁾	=	57.00	

Pressures (Energies)**Method Transducer**

Pmax	=	1800 bar	
PK	=	2070 bar	
PE	=	2340 bar	
M	=	25.00	

Miscellaneous Dimensions

Fe ¹⁾³⁾	=	0.15	
delta L	=	0.02	

CHAMBER MINI**Lengths**

L1	=	46.15	
L2	=	48.84	
L3	=	57.30	

Breech

R	=	1.30	
R1	=	12.00	
R2	=		
R3	=		
r	=		

Powder Chamber

E	=	3.19	
P1	=	11.97	
P2 *	=	10.98	

Junction Cone

alpha	=	38°19'59"	
S *	=	61.95	
r1 max	=	0.50	
r2	=	0.50	

Collar

H1 *	=	9.11	
H2 ¹⁾	=	9.10	

Commencement of Rifling

G1 ¹⁾ *	=	5.00	
G	=		
alpha1	=	60°	
h *	=	3.55	
s	=		
i	=		
w	=		

Barrel

F ¹⁾ *	=	5.00	
Z	=		

Grooves

b	=		
N	=		
u	=		
Q	=	19.63	mm ²

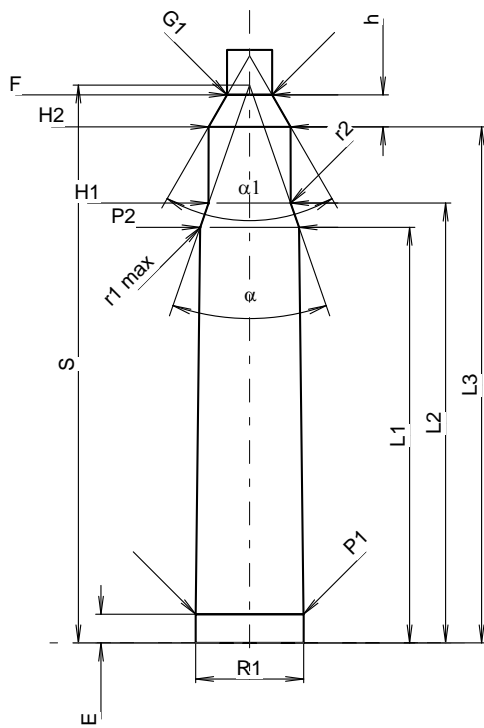

Scale 1.19:1

Dimensions in << mm >>
 Dimensions and Tolerances for Proof Barrels
 see Appendix CR 5.

Notes: 1) Check for safety reasons
 2) Valid only for Proof barrels
 3) Headspace on Shoulder
 * Basic dimensions