

C.I.P.**18 x 81**

TAB. X

Datum 99-02-22

Revision 00-06-07

Ursprungsland: CZ

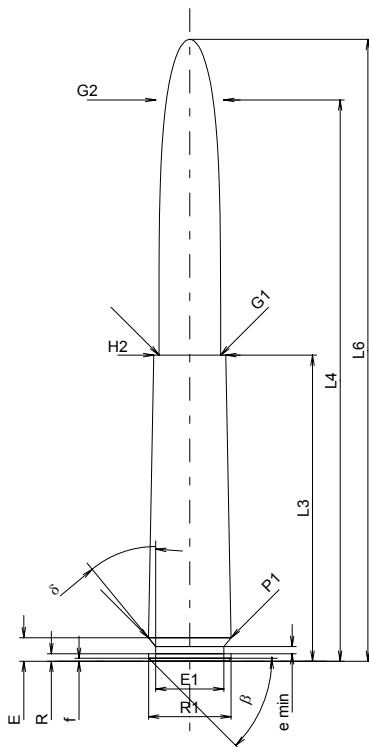
**PATRONE MAXI****Längen**

L1	=	
L2	=	
L3 ¹⁾	=	81.00
L4	=	148.50
L5	=	
L6	=	164.50

Hülsenboden

R	=	2.00
R1	=	21.80
R3	=	
E	=	6.24
E1	=	18.00
e min	=	1.90
δ	=	39°30'55"
f	=	0.80
β	=	45°

Pulverkammer

P1	=	21.85
P2	=	

Schulterkonus

α	=	
S	=	
r1 min	=	
r2	=	

Hülsenhals

H1	=	
H2 ¹⁾	=	19.10

Geschoß

G1 ¹⁾	=	16.30
G2	=	17.95
F	=	
L3+G ¹⁾	=	82.85

Drücke (Energien)**Mechan. elektr. Wandler**

Pmax	=	3550 bar
PK	=	4083 bar
PE	=	4615 bar
M	=	82.25

Verschiedene Daten

Fe	=	
delta L	=	

PATRONENLAGER MINI**Längen**

L1	=	
L2	=	
L3 ¹⁾	=	80.80

Stossboden

R	=	
R1	=	21.95
R2	=	
R3	=	
r	=	

Pulverkammer

E	=	6.24
P1 ¹⁾	=	21.95
P2	=	

Schulterkonus

α	=	
S	=	
r1 max	=	
r2	=	

Hülsenhals

H1	=	
H2 ¹⁾	=	19.20

Übergang

G1	=	
G ¹⁾ *	=	1.85
α1	=	
h	=	
s	=	
i ¹⁾	=	17°58'09"
w	=	

Lauf

F ¹⁾ *	=	18.00
Z	=	

Züge

b	=	
N	=	
u	=	
Q	=	254.47 mm ²

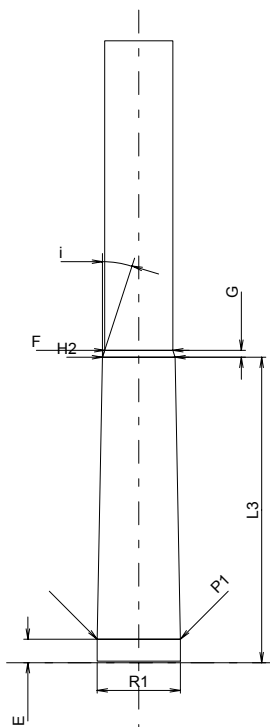

Maßstab 1:2

Maße in << mm >>
Maße und Toleranzen für Messläufe
siehe Anhang CR 1.

Bemerkungen: 1) Kontrolle aus Sicherheitsgründen
* Grundmaße